

BENCHMADE[®]



K N I F E C O M P A N Y



THE OFFICIAL BENCHMADE 2003 CATALOG

THE CONTENTS

BENCHMADE DISTINCTION	...pages 2-3
MAXIMUM FUNCTION AXIS	...pages 3-4
THE CUSTOM DESIGN TEAM	...page 3
AXIS FUNCTION FOLDERS	...pages 6-16
MORE GREAT FOLDERS	...pages 17-23
SPECIAL EDITIONS	...pages 24-25
FIXED BLADE MODELS	...pages 26-31
PURE BALI-SONG	...pages 32-34
A PRESTIGEDGES KITCHEN	...page 35
BEYOND THE EDGE	...page 36
SPECIAL INGREDIENTS	...pages 36-37
ACCESSORIES	...pages 38-39
SHOW'EM THE BRAND	...pages 39-40
WARRANTY & PRICING	...inside back cover
EVERYTHING ELSE	... benchmade.com

benchmade.com

MAXIMUM DISTINCTION

It's More Than Form And Function.
It Goes *Beyond The Edge Of Knives*.
It's Personal.
It's Benchmade.



The following pages provide considerably more information than any other knife company. Two reasons. We are not like other knife companies. We are definitely not like other knife companies.

THE BENCHMADE DIFFERENCE



FORM & FUNCTION The standard in single-handed functioning. Benchmade Knife Company engineers and manufactures a diversity of folders featuring several unique locking mechanisms, including our own exclusive patented **AXIS™** lock which is totally ambidextrous and continues to dominate the industry. **NEW!** this year is the patent pending **LEVITATOR™** lock which is sure to turn some heads, too. Other mechanisms include our patented modified locking-liners, lock-backs and automatic openers. Or if you're in need of a well-designed fixed blade, we offer several great options there as well. ● Blade shapes are model specific, and Benchmade offers a multitude of blade configurations in each model. These include: plain edge; ComboEdge® (*with partial serrations*), and fully-serrated edge (*limited models only*). Additionally, blades are available in several finishes including: satin, BT2® coated for corrosion resistance, and Boron Carbide (BC1™) on several models (*see particular model specifications for edge and finish availability*). And in several models you even get the option of two different blade steels. ● When selecting a knife, consider the tasks you wish to perform and the circumstances you could potentially face, then determine which style offers the most benefit for you. Notably, most Benchmade knives are intentionally designed for maximum utility. 🦋

FEATURES Benchmade manufactures a modified locking-liner on the rear tang of the blade. This patented feature helps to ensure the locking-liner fully engages for optimum safety. It's used exclusively on all of our locking-liner designs. ● Another added knife feature with Benchmade is the adjustable blade-pivot screw. You can readily tension the blade drag to your personal preference, and the pivot screws are larger than average for increased strength. All Benchmade blades operate exceptionally smooth with little or no side-to-side "wobble." Knife blades are very sharp right out of the box too. ● Stainless steel carry-clips are anchored (*removable*) to knife handles with six-lobe (*Torx® style*) screws for secure carry versatility and ease of access. ● That same engineered screw style is used throughout the knives for a superior means of achieving a "tighter" fit through a more controllable tooling system. And to take it one step further, we use stainless steel screw-receiver inserts wherever warranted. Threaded inserts help prevent stripping of screws while at the same time providing a solid anchoring point for component assembly. 🦋



Torx® is a registered trademark of Camcar Textron, Inc.

IT'S BENCHMADE

DISTINCTION Overbuilt? Maybe. But at Benchmade we do things our own way. We are involved in the design and manufacturing of each component in every knife we make from start to finish. Benchmade has close associations with several of the world's premiere custom knife makers who provide some of the latest innovations and



functional designs. A dedicated work force utilizes the newest technologies available including laser cutting to tolerances of .0005-inches which equates to slicing a human hair into 16 layers. From there, the CNC machining centers and a host of other advanced production equipment helps to shape each piece into a "Benchmade fit" cutting tool. Our components are precisely manufactured to assemble with tight tolerances without requiring any additional fit and finish work to mask any inaccuracies. ● It all comes together in a higher standard of fit, form and function— unparalleled, even by some custom knife makers' standards. 🦋



work force utilizes the newest technologies available including laser cutting to tolerances of .0005-inches which equates to slicing a human hair into 16 layers. From there, the CNC machining centers and a host of other advanced production equipment helps to shape each piece into a "Benchmade fit" cutting tool. Our components are precisely manufactured to assemble with tight tolerances without requiring any additional fit and finish work to mask any inaccuracies. ● It all comes together in a higher standard of fit, form and function— unparalleled, even by some custom knife makers' standards. 🦋



A Benchmade knife has been selected as Knife-of-the-Year each of the last 5 years (1998-2002) by the over 300 voting members of the Academy of Excellence.

PASSION You must have it to succeed. At Benchmade, we shape it, we build it and then we put it into blue boxes for the rest of the world to share. And to make certain it never dies, we established the Benchmade Custom Design Team. It's founded on the premise of a high regard for the individual custom knife maker and what they represent to the knife industry. These skilled artisans and craftsmen pour their genuine passions, and employ their given talents into making unique realities one piece at a time. They are continually developing new innovations and fresh designs which improve the form and function of knives. ● By working closely with a selection of world-class custom designers, Benchmade is able to tap into the newest locking mechanisms, modern materials, and the latest designs. Ultimately, a collaboration between designer and manufacturer transpires into something special that previously may have only been enjoyed by a fortunate few. 🦋

THE DESIGNERS

PARDUE

Mel Pardue has been shaping knives and grinding sparks for 20-plus years now. His style has a class and simplicity all its own. His Benchmade collaborations offer great utility to the everyday knife user while at the same time presenting an upscale distinction. Less is definitely more when it comes to Mel's designs.

McHENRY & WILLIAMS

It runs in the family... Bill McHenry and stepson Jason Williams spend their days making exquisite pieces of "art with an edge on it". Bill's fine art and metalsmithing heritage combine well with Jason's mechanical background, and together they have been responsible for introducing numerous noteworthy innovations into the knife making world. Benchmade was fortunate to be involved with one such innovation, the revolutionary AXIS™ locking mechanism. Some have proclaimed it to be "the strongest folding lock mechanism EVER." And this year they bring the LEVITATOR™ locking mechanism which will impress as well... What's next?

OSBORNE

Warren Osborne got into knife making by circumstance... Being raised in the farming and ranching industry taught him early on what great utility a quality knife can offer. How a knife feels in the hand over extended use, blade design and materials as well as the quality with which it is made are all mandatory parts to an Osborne design.

MAXIMUM FUNCTION

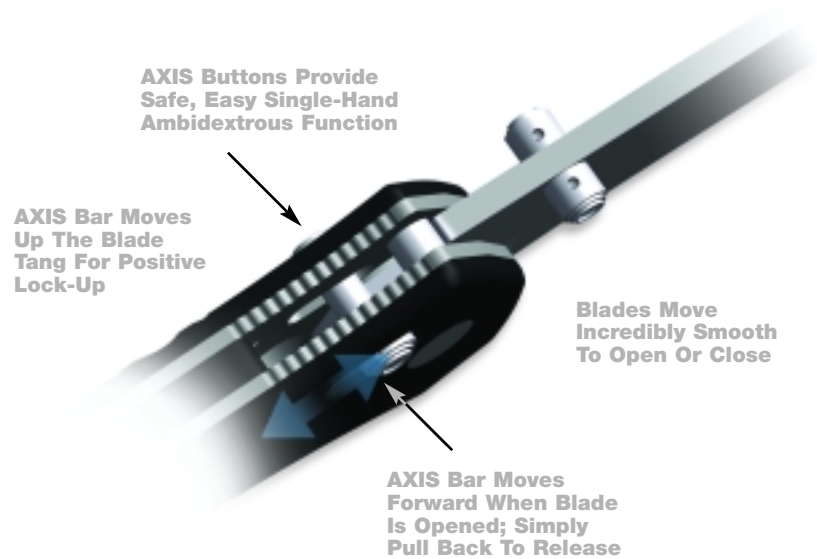

AXIS Buttons Provide Safe, Easy Single-Hand Ambidextrous Function

AXIS Bar Moves Up The Blade Tang For Positive Lock-Up

Blades Move Incredibly Smooth To Open Or Close

AXIS Bar Moves Forward When Blade Is Opened; Simply Pull Back To Release

INNOVATION

IT GOES WAY BEYOND STRENGTH

Which came first— AXIS function or AXIS strength? ● AXIS was the brain child of custom knife makers Bill McHenry and Jason Williams. They set out to create a mechanism which would improve knife function and be easy and safe for people to use. ● After all, isn't that what *you* look for most in a knife? Looks, feel, blade style, easy to open and close, quality, safety... Then comes the subjective area, strength. ● So how strong is AXIS? Plenty. That's the truly unique thing about AXIS. It has everything you look for in a knife mechanism and *more*. Just ask the competition. 🦋

THE AXIS ADVANTAGE

A Benchmade exclusive, the patented AXIS locking mechanism is an ingenious, original-engineering marvel. Functional yet intuitively simple. ● **THE AMBIDEXTROUS ADVANTAGE**— Knife blades can be readily actuated open or closed with either hand. ● **THE SAFETY ADVANTAGE**— Single-hand actuation without having to place flesh in the blade path.

THE "SMOOTHNESS" ADVANTAGE— An indescribable smoothness is experienced with the mechanism and blade. By design there are no traditional "friction" parts to the AXIS mechanism, making the function all that much smoother. ● **THE STRENGTH ADVANTAGE**— This lock is definitely more than adequate for the demands of a cutting tool and normal knife use. ● **THE MECHANICS**— Basically, AXIS gets its function from a small hardened steel bar (A) which rides forward and back in a slot machined into both steel liners (B). The bar extends to both sides of the knife; spanning the space between the liners and is positioned over the rear of the blade. It engages a ramped notch cut into the tang portion of the knife blade when it is opened. Two omega style springs (C), one on each liner, give the locking bar its inertia to engage the knife tang, and as a result the tang is wedged solidly between a sizable stop pin (D) and the AXIS bar itself. ● It's a lot of words in an attempt to describe simplicity. The very best way to truly appreciate the AXIS lock is to experience it for yourself firsthand. 🦋

U.S. PATENT
No. 5,737,841

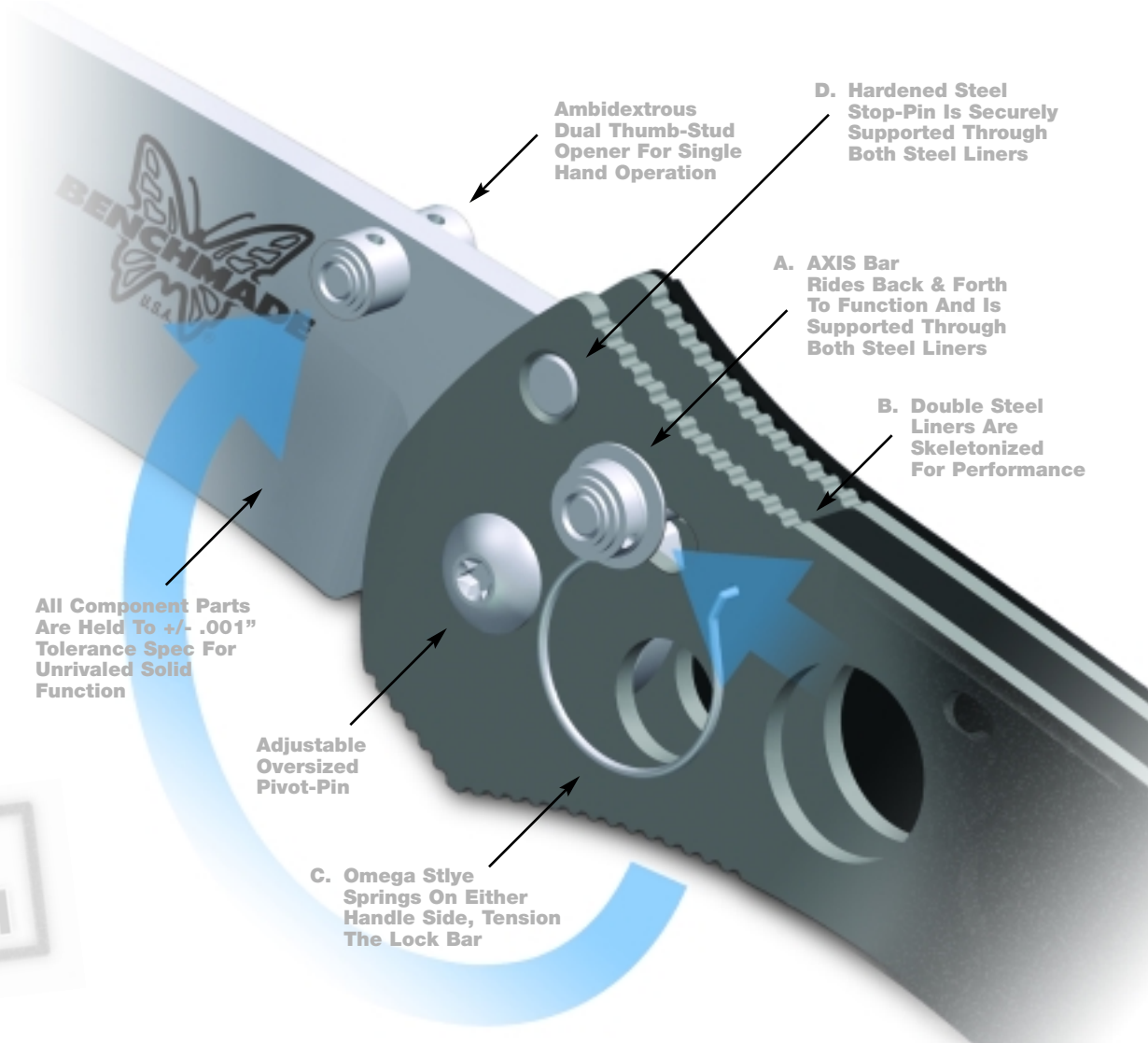

All Component Parts
Are Held To +/- .001"
Tolerance Spec For
Unrivaled Solid
Function

Ambidextrous
Dual Thumb-Stud
Opener For Single
Hand Operation

D. Hardened Steel
Stop-Pin Is Securely
Supported Through
Both Steel Liners

A. AXIS Bar
Rides Back & Forth
To Function And Is
Supported Through
Both Steel Liners

B. Double Steel
Liners Are
Skeletonized
For Performance

Adjustable
Oversized
Pivot-Pin

C. Omega Style
Springs On Either
Handle Side, Tension
The Lock Bar

OSBORNE

MODEL 921 SWITCHBACK™ NEW! Our first dual blade offering, this synthesis of fluid curves, mechanical motion and advanced technologies is a distinctive assertion of mind over matter. ● It explodes with functional opportunity by incorporating an unrivaled AXIS actuated main blade with a slip-jointed second blade out the back end. ● Lean on girth and big on satisfaction, the Model 921 fits the pocket with all of the right stuff. 🦋

MODEL 921 SWITCHBACK – Designer: Osborne; Main Blade- Blade Material: S30V Stainless Steel Hardened to 58-60HRC; Length: 3.40" (8.64cm); Thickness: .115" (2.92mm); Open: 7.87" (19.99cm); Small Blade- Blade Material: 440C Stainless Steel Hardened to 58-60HRC; Length: 2.00" (5.08cm); Thickness: .115" (2.92mm); Open: 7.87" (19.99cm); Knife Closed: 4.47" (11.35cm); Weight: 2.90oz (82gm); Handle: Blue Color Anodized 6061-T6 Aluminum, Double 410 Stainless Steel Liners; Handle Thickness: 0.41" (1.04cm); Lock Mechanism: AXIS Lock; Slip-Joint (Small Blade); Blade Style & Opener: Wharncliff, Ambidextrous Dual Thumb-Stud; Nail-Nick (Small Blade)

Available Blade Configurations – ● **MODELS 921** ● **MODELS 921S**

See inside back cover for listing of configurations and pricing.

BACK BLADE ADDS BOTH
A VISUAL AND
FUNCTIONAL EDGE

MODEL 921

CLASSIC BARE METAL FINISHES ARE
SUPER CHARGED BY A PULSE OF
ELECTRIC BLUE COLOR

THE SECOND BLADE'S PRACTICAL
DESIGN TRANSLATES INTO
USEFUL HARDWARE—

OSBORNE

MODEL 770

ULTRA-LIGHT, COMPACT DESIGN
TRAVERSES THE REALM OF
USER INTERESTS

THE SPACE AGE CARBON FIBER
COMPOSITE ADDS TO THE
CREATION OF A POCKET OF
ROCKET SCIENCE

MODEL 770BC1

MODEL 771

MODEL 771-01

MODEL 773

MODEL 770 SERIES A distinctive carry which boldly edges the legacy of gentlemen's folders into the 21st century with the enhancements of space age composites and functional innovation. ● Choice of carbon fiber or aluminum handle skins wrap the precision inset AXIS chassis like a custom tailored business suit. ● Opt for boron carbide (BC1) blade coating for the ultimate in scratch resistance. ● Unlike a piece of fine jewelry, a gent knife must blend form with function. The 770 Series proves the formula. ♀

MODEL 770 AXIS LOCK— Designer: Osborne; Blade Material: 154CM Stainless Steel Hardened to 58-60HRC; Length: 2.80" (7.40cm); Thickness: 0.94" (2.40mm); Open: 6.50" (16.50cm); Closed: 3.70" (9.40cm); Weight: 1.60oz (45gm); Handle: Black Carbon Fiber Scales, Double 410 Stainless Steel Partial Liners; Polished Steel Carry-Clip; Handle Thickness: 0.39" (0.99cm); Lock Mechanism: AXIS Lock; Blade Style & Opener: Clip-Point; Faceted Ambidextrous Dual Thumb-Stud

Available Blade Configurations— ● **MODEL 770** ● **MODEL 770BC1**
See inside back cover for listing of configurations and pricing.

MODELS 771, 773 & 771-01 AXIS LOCK— NOTE: Dimensions and weights same as Model 770 above; Handles: Clear, Black or Red/Black Color Splash Anodized Aluminum Scales, Double 410 Stainless Steel Partial Liners; Polished Steel Carry-Clip; Handle Thickness: 0.39" (0.99cm); Lock Mech: AXIS Lock; Blade Style & Opener: Clip-Point, Ambidex. Dual Thumb-Stud

Available Blade Configurations—
● **MODELS 771 & 773** ● **MODELS 771BC1 & 773BC1**
● **MODELS 771-01** ● **MODELS 771BC1-01**

See inside back cover for listing of configurations and pricing.

MC HENRY & WILLIAMS

MODELS 710 & 705 It's the stuff legends are made of—the knife that started the *AXIS* revolution!

- A design so pure that it does very well over a wide spectrum of uses.
- G10 handle skins provide slip-resistant surface grip and will stand up to years of service.
- A modern clip-point blade interpretation puts the slice back into the utility blade, and its reverse curve edge is an ideal addition for efficiency. And if you really want to take it up a notch, the M2 version offers the ultimate edge hold.
- Size is definitely a personal thing, so pick your pleasure. 🦋

MODEL 710 AXIS LOCK FOLDER— Designers: McHenry & Williams; Blade Material: 154CM Stainless Steel Hardened to 58-60HRC or M2 High-Speed Steel Hardened to 60-62HRC; Length: 3.90" (9.90cm); Thickness: .115" (2.92mm); Open: 8.80" (22.34cm); Closed: 4.90" (12.44cm); Weight: 4.50oz (128gm); Handle: Black G10 Scales, Double 410 Stainless Steel Liners; Movable Steel Carry-Clip; Handle Thickness: 0.48" (1.22cm); Lock Mechanism: AXIS Lock; Blade Style & Opener: Modified Clip-Point, Dual Thumb-Stud

Available Blade Configurations— ● **MODEL 710**
● **MODEL 710S** ● **MODEL 710SBT**
● **MODEL 710HS** ● **MODEL 710HSSR**
● **MODEL 710T**

See inside back cover for listing of configurations and pricing.



AVAILABLE WITH—
TRAINER SAFE BLADE

MODEL 710T

MODEL 705 AXIS LOCK FOLDER— Designers: McHenry & Williams; Blade Material: 154CM Stainless Steel Hardened to 58-60HRC; Length: 2.95" (7.50cm); Thickness: .100" (2.54mm); Open: 6.75" (17.15cm); Closed: 3.80" (9.65cm); Weight: 2.70oz (77gm); Handle: Black G10 Scales; Double 410 Stainless Steel Liners; Movable Steel Carry-Clip; Handle Thickness: 0.41" (1.04cm); Lock Mechanism: AXIS Lock; Blade Style & Opener: Modified Clip-Point; Dual Thumb-Stud

Available Blade Configurations—

● **MODEL 705** ● **MODEL 705S** ● **MODEL 705SBT**

See inside back cover for listing of configurations and pricing.

NO HIDDEN AGENDAS,
NO EXCESS BAGGAGE,
AND NO EXCUSES



MODEL 710

MODEL 705SBT

BLADE DESIGN THAT HANDLES
INCREDIBLY WELL, BIG
OR SMALL.

OSBORNE

MODEL 940 SERIES

A progression in design exemplified in glassy smooth function and stealthy structure. ● Intelligently contoured aircraft-grade aluminum handle forms go the distance for light-weight, sure-finger grip. ● Variants of two blade styles push the outer limits of utility, and the premium steel holds its sharp edge well. ● Unsurpassed AXIS lock mechanics are set into motion with a thumb flick of the ambidextrous thumb-stud. You choose the pocket to clip into with the movable steel carry-clip. ● From chores around your urban world to adventurous exploration outdoors, make the cut— go 940. 🦋

*ACTION SO SMOOTH, IT
DEFIES WORDS. ONLY TO BE
EXPERIENCED FIRST HAND*

MODEL 941

MODEL 942SBT

*A UNIQUE BLADE SHAPE
LIMITED ONLY BY ONE'S
"MISPERCEPTION"*

MODEL 940S



MODEL 941

MODEL 942SBT



MODEL 943



MODEL 940 & 942 AXIS LOCK— Designer: Osborne; Blade Material: 154CM Stainless Steel Hardened to 58-60HRC; Length: 3.40" (8.64cm); Thickness: .115" (2.92mm); Open: 7.87" (19.99cm); Closed: 4.47" (11.35cm); Weight: 2.90oz (82gm); Handle: Green/940 or Black/942 Color Anodized 6061-T6 Alum.; Double 410 Stainless Steel Liners, Color Anodized Titanium Back Spacer; Movable Steel Carry-Clip; Handle Thickness: 0.41" (1.04cm); Lock Mechanism: AXIS Lock; Blade Style & Opener: Modified Reverse Tanto, Ambidextrous Dual Thumb-Stud

Available Blade Configurations—

- **MODELS 940 & 942** ○ **MODELS 940S & 942S**
- ◐ **MODELS 940SBT & 942SBT**

See inside back cover for listing of configurations and pricing.

MODEL 941 & 943 AXIS LOCK— Designer: Osborne; Blade Material: 154CM Stainless Steel Hardened to 58-60HRC; Length: 3.40" (8.64cm); Thickness: .115" (2.92mm); Open: 7.87" (19.99cm); Closed: 4.47" (11.35cm); Weight: 2.62oz (74gm); Handle: Green/941 or Black/943 Color Anodized 6061-T6 Alum.; Double 410 Stainless Steel Liners, Color Anodized Titanium Back Spacer; Movable Steel Carry-Clip; Handle Thickness: 0.41" (1.04cm); Lock Mechanism: AXIS Lock; Blade Style & Opener: Straight Clip-Point, Ambidextrous Dual Thumb-Stud

Available Blade Configurations—

- **MODELS 941 & 943** ○ **MODELS 941S & 943S**
- ◐ **MODELS 941SBT & 943SBT**

See inside back cover for listing of configurations and pricing.

BENCHMADE

MODELS 806D2 AFCK & 805 TSEK

Stainless steel, G10 composite and AXIS function converge into an almost immortal state of reality. ● The human hand tenaciously conforms to the curvature of the AFCK handle. Two unique blade designs open up to run the gamut of utility. ● And for the hard core knife user, the steel carry-clip is movable for tip-up, tip-down, side-to-side carry options. ● Its brute beauty is in the eye of the holder. 🦋

MODEL 806D2 AFCK AXIS LOCK— Blade Material: D2 Tool Steel Hardened to 59-61HRC; Length: 3.94" (10cm); Thickness: .124" (3.15mm); Open: 9.37" (23.80cm); Closed: 5.43" (13.79cm); Weight: 4.78oz (135gm); Handle: Black G10 Scales, Double 410 Stainless Steel Liners; Movable Steel Carry-Clip; Handle Thickness: 0.49" (1.25cm); Lock Mechanism: AXIS Lock; Blade Style & Opener: Clip-Point, Ambidextrous Oval Thumb-Hole

Available Blade Configurations— ● **MODEL 806D2** ● **MODEL 806SD2**
See inside back cover for listing of configurations and pricing.

MODEL 805 TSEK AXIS LOCK— Blade Material: 440C Stainless Steel Hardened to 58-60HRC; Length: 3.93" (9.98cm); Thickness: .124" (3.15mm); Open: 9.36" (23.77cm); Closed: 5.43" (13.79cm); Weight: 4.74oz (134gm); Handle: Black G10 Scales, Double 410 Stainless Steel Liners; Movable Steel Carry-Clip; Handle Thickness: 0.49" (1.25cm); Lock Mechanism: AXIS Lock; Blade Style & Opener: Modified Drop-Point, Ambidextrous Dual Thumb-Stud

Available Blade Configurations—
● **MODEL 805** ● **MODEL 805S** ● **MODEL 805SBT**
See inside back cover for listing of configurations and pricing.

**MODEL 806SD2
AFCK**

**MODEL 805
TSEK**

ONE TENACIOUS HANDLE DESIGN.
TWO BLADE CONFIGURATIONS.
YOU'RE WELCOME.

MODELS 806D2 & 806SD2 AFCK

MODELS 805 & 805S TSEK

BENCHMADE

MODELS 730 & 735 ARES™ Sculpted contours of G10 color purposefully shroud the existence of a much deeper skeleton structure. ● Top-to-bottom, end-to-end it's like a canvas of innovation precisely balanced on an **AXIS** of unrivaled function. ● The tool design effectively uses a thicker spear-point blade shape to cut away any myths of its abilities to get the job done. ● The Ares declares war on utility and possesses the arsenal of performance features to be victorious. 🦋

MODELS 730 & 735 ARES AXIS LOCK— Blade Material: 154CM Stainless Steel Hardened to 58-60HRC; Length: 3.60" (9.14cm); Thickness: .114" (2.90mm); Open: 8.20" (20.83cm); Closed: 4.70" (11.94cm); Weight: 4.40oz (125gm); Handle: Multi-Color G10 Scales, Double 410 Stainless Steel Liners; Movable Steel Carry-Clip; Handle Thickness: 0.56" (1.43cm); Lock Mechanism: **AXIS Lock**; Blade Style & Opener: Spear-Point, Ambidextrous Dual Thumb-Stud

Available Blade Configurations— ● **MODELS 730 & 735**
● **MODELS 730S & 735S** ● **MODELS 730SBT & 735SBT**

See inside back cover for listing of configurations and pricing.

LAYERS OF ALTERNATING COLOR
RENDER HANDLE SHAPE
AND DIMENSION.

**MODEL 730
ARES**



**MODEL 735SBT
ARES**

COMPONENTS COME TOGETHER
FOR A FIT AND FINISH RARELY FOUND
IN MANUFACTURED CUTLERY.



**MODEL 550
GRIPTILIAN**



**MODEL 556S
MINI-GRIPTILIAN**

FULL OR MINI, AMBIDEXTROUS OVAL THUMB-HOLE OR STUD— CHOOSE THE CREATURE THAT BEST FITS YOUR HABITAT

PARDUE

GRIPTILIAN SERIES The unmatched function of AXIS combined with the simplicity of a molded handle design— *get a grip!* ● It's a new species of knife. Safe. Reliable. Smooth. Affordable. ● Grip in two blade styles and two knife sizes. ● Griptilian performance is keenly unleashed with a simple thumb rotation, either right or left handed, you choose. ● The hand settles naturally over the palm swelled shape and its textured skin. ● So don't hold back, go wild and — **GET A GRIP!** Grrrr!

MODEL 550SBT



MODEL 551

**NEW!
MODEL 5510D**

MODEL 550SBTRT



—AVAILABLE WITH REALTREE® HARDWOODS®

MODEL 551SBTRT

MODEL 550T

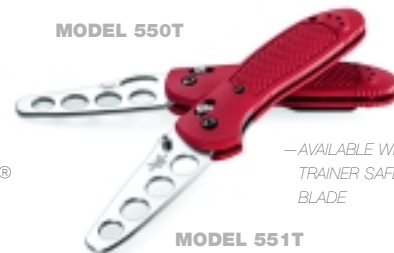

—AVAILABLE WITH TRAINER SAFE BLADE

MODEL 551T

MODELS 550 & 551 GRIPTILIAN AXIS— Designer: Pardue; Blade Material: 440C Stainless Steel Hardened to 58-60HRC; Length: 3.45" (8.76cm); Thickness: .115" (2.92mm); Open: 8.07" (20.50cm); Closed: 4.62" (11.73cm); Weight: 3.25oz (92gm); Handle: Black Glass Fill Noryl GTX/Color Valox; Double 410 Stainless Steel Liners; Reversible Steel Carry-Clip; Handle Thickness: 0.64" (1.63cm); Lock Mechanism: AXIS Lock; Blade Style & Opener: Model 550— Modified Sheepsfoot; Ambidextrous Oval Thumb-Hole; Model 551— Modified Drop-Point; Ambidextrous Dual Thumb-Stud

Available Blade Configurations— ● **MODEL 550** ◐ **MODEL 550S**
 ◐ **MODEL 550SBT** ● **MODEL 550OD** ◐ **MODEL 550SOD**
 ● **MODEL 550BTOD** ◐ **MODEL 550SBTOD** ◐ **MODEL 550SBTRT**
 ● **MODEL 550T** See inside back cover for listing of configurations and pricing.

Available Blade Configurations— ● **MODEL 551** ◐ **MODEL 551S**
 ◐ **MODEL 551SBT** ● **MODEL 551OD** ◐ **MODEL 551SOD**
 ● **MODEL 551BTOD** ◐ **MODEL 551SBTOD** ◐ **MODEL 551SBTRT**
 ● **MODEL 551T** See inside back cover for listing of configurations and pricing.

MODELS 555 & 556 MINI-GRIPTILIAN AXIS— Designer: Pardue; Blade Material: 440C Stainless Steel Hardened to 58-60HRC; Length: 2.91" (7.38cm); Thickness: .100" (2.54mm); Open: 6.78" (17.21cm); Closed: 3.87" (9.82cm); Weight: 2.56oz (73gm); Handle: Color Valox; Double 410 Stainless Steel Liners; Reversible Steel Carry-Clip; Handle Thickness: 0.51" (1.30cm); Lock Mechanism: AXIS Lock; Blade Style & Opener: Model 555— Modified Sheepsfoot; Ambidextrous Oval Thumb-Hole; Model 556— Modified Drop-Point; Ambidextrous Dual Thumb-Stud

Available Blade Configurations— ● **MODEL 555** ◐ **MODEL 555S**
 ◐ **MODEL 555SBT** ● **MODEL 555OD** ◐ **MODEL 555SOD**
 ● **MODEL 555BTOD** ◐ **MODEL 555SBTOD** ● **MODEL 555-GRN**
 ● **MODEL 555S-GRN** ● **MODEL 555-PUR** ◐ **MODEL 555S-PUR**
 ● **MODEL 555-YEL** ◐ **MODEL 555S-YEL** ● **MODEL 555-BLU**
 ◐ **MODEL 555S-BLU** See inside back cover for listing of configurations and pricing.

Available Blade Configurations— ● **MODEL 556** ◐ **MODEL 556S**
 ◐ **MODEL 556SBT** ● **MODEL 556OD** ◐ **MODEL 556SOD**
 ● **MODEL 556BTOD** ◐ **MODEL 556SBTOD** ● **MODEL 556-GRN**
 ◐ **MODEL 556S-GRN** ● **MODEL 556-PUR** ◐ **MODEL 556S-PUR**
 ● **MODEL 556-YEL** ◐ **MODEL 556S-YEL** ● **MODEL 556-BLU**
 ◐ **MODEL 556S-BLU** See inside back cover for listing of configurations and pricing.

POUND FOR POUND, DOLLAR FOR DOLLAR,
 ONE OF THE BEST KNIVES AVAILABLE

NEW!
MODEL 555-BLU
MINI-GRIPTILIAN

MODEL 555S-GRN
MINI-GRIPTILIAN

MODEL 556
MINI-GRIPTILIAN



MODEL 556S-PUR
MINI-GRIPTILIAN

NEW!
MODEL 556-YEL
MINI-GRIPTILIAN

PARDUE

MODEL 720SBT

AN ATYPICAL HANDLE DESIGN
SURPRISES THE HAND WITH
A WELCOMED FEEL

MODEL 720



MODEL 720SBTRT



—AVAILABLE
WITH REALTREE®
HARDWOODS®

MODEL 721



MODEL 722SBT

MODEL 722S

MODELS 720 SERIES An accomplishment in mid-size design and overbuilt toughness. ● Blades come in Bowie or Tanto, both heavy on tip strength and long on edge retention. ● Opt for either aluminum or G10 exteriors to harness the AXIS blade mechanics. ● The short stature clips low in the pocket, and its rounded form goes almost unnoticed. 🦋

MODEL 720 AXIS LOCK— Designer: Pardue; Blade Material: 154CM Stainless Steel Hardened to 58-60HRC; Length: 3.25" (8.26cm); Thickness: .115" (2.92mm); Open: 7.62" (19.35cm); Closed: 4.37" (11.10cm); Weight: 4.30oz (122gm); Handle: Black Anodized 6061-T6 Aluminum Scales, Double 410 Stainless Steel Liners; Movable Steel Carry-Clip; Handle Thickness: 0.47" (1.20cm); Lock Mechanism: AXIS Lock; Blade Style & Opener: Bowie, Ambidextrous Dual Thumb-Stud

Available Blade Configurations— ● **MODEL 720** ● **MODEL 720S**
● **MODEL 720SBT** ● **MODEL 720SBTRT**

See inside back cover for listing of configurations and pricing.

MODELS 721 & 722 AXIS LOCK— Designer: Pardue; Blade Material: 154CM Stainless Steel Hardened to 58-60HRC; Length: 3.25" (8.26cm); Thickness: .115" (2.92mm); Open: 7.62" (19.35cm); Closed: 4.37" (11.10cm); Weight: 3.82oz (108gm); Handle: Black G10 Scales, Double 410 Stainless Steel Liners; Movable Steel Carry-Clip; Handle Thickness: 0.49" (1.25cm); Lock Mechanism: AXIS Lock; Blade Style & Opener: Bowie or Tanto, Ambidextrous Dual Thumb-Stud

Available Blade Configurations— ● **MODELS 721 & 722**
● **MODELS 721S & 722S** ● **MODELS 721SBT & 722SBT**

See inside back cover for listing of configurations and pricing.

MC HENRY & WILLIAMS

MODEL 310 BENCHMITE™ NEW! Mind teasing innovation is put into motion in this cutting edge design. ● An ingenious mechanical Levitator™ system (*patent pending*) in the Titanium handle scale leverages the spring/pin system to effectively lock the blade open and closed. ● The stylish blade shape makes the cut with its high-grade blade steel. ● A multitude of laser cut and precision machined components come together in a pocket friendly representation of modern engineering wizardry. 🦋

MODEL 310 BENCHMITE— Designer: McHenry & Williams; Blade Material: 154CM Stainless Steel Hardened to 58-60HRC; Length: 1.92" (4.88cm); Thickness: 0.084" (2.13mm); Open: 4.75" (12.07cm); Closed: 2.85" (7.24cm); Weight: 1.00oz (28gm); Handle: Blue Color Anodized Titanium; Handle Thickness: 0.23" (0.58cm); Lock Mechanism: Levitator Lock; Blade Style & Opener: Clip-Point, Nail-Nick

Available Blade Configurations— ● **MODEL 310**
See inside back cover for listing of configurations and pricing.

BY PUSHING IN ON THE LEVITATOR MECHANISM IN THE TITANIUM HANDLE SCALE (1), THE LOCK PIN (2) MOVES OUT AND DISENGAGES

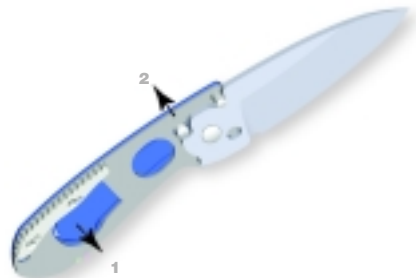

A ONE OUNCE BLEND OF FORM AND FUNCTION FOR THE INDIVIDUAL WHO APPRECIATES THE TRUE VALUE OF AN EDGE, NO MATTER HOW SMALL



NEW!
MODEL 310
BENCHMITE

MODEL 690

*THE COMBINATION OF COLOR,
RAW STEEL AND RIGHTEOUS ATTITUDE
EVOKE AN UNWAVERING CONFIDENCE*



MODEL 690 Shattering the envelope of manufacturing technology beyond the limits of traditional thought. ● Stabilized hardwood and carbon fiber are fashioned as one and staged against blue anodized titanium liners to visually express your personal good tastes in style. ● A premium blade steel single-handedly cuts away any misconceptions of all edges being equal when it comes to knives. ● Clip in for cool with the hefty stone-washed metal carry-clip, and you're good to go. ● With the 690, there's no bad seat in the house— it's a box seat from every angle. 🦋

MODEL 690BC1

*THE ONLY DECISION LEFT IS WHETHER TO
LEAVE THE BLADE NATURAL FINISH OR OPT
FOR THE SPACE AGE BORON CARBIDE
SCRATCH INHIBITOR...*

MODEL 690 – Blade Material: 154CM Stainless Steel Hardened to 58-60HRC; Length: 3.25" (8.26cm); Thickness: .133" (3.38mm); Open: 7.50" (19.00cm); Closed: 4.12" (10.50cm); Weight: 3.00oz (85gm); Handle: Black Carbon Fiber/Stabilized Rose Wood Scales; Double Blue Anodized Titanium Liners; Handle Thickness: 0.54" (1.38cm); Lock Mechanism: Modified Locking-Liner; Blade Style & Opener: Clip-Point; Movable Thumb-Stud

Available Blade Configurations –

- **MODEL 690** ● **MODEL 690S** ● **MODEL 690BC1**
● **MODEL 690SBC1** See inside back cover for listing of configurations and pricing.



A HONED DESIGN AND COMPETENT CONSTRUCTION ENSURE THE REALITY OF HARD USE RATHER THAN THE PERCEPTION

MODEL 910SBT STRYKER



MODEL 905 MINI-STRYKER

MODELS 910 STRYKER® & 905 MINI-STRYKER

An angular approach leads to blade geometry of monolithic proportion. Perhaps a misunderstood overachiever in efficiencies of cutting. ● The abundance of blade strength is anchored in titanium liners with an exterior armor of G10 for a virtually indestructible gripping surface. ● Solid lock-up is a derivative of the patented modified locking-liner and its distinctive "click" to lock position. ● Ponder two Stryker sizes, both are prodigies of cutting performance in the knife world. 🦋

AVAILABLE WITH TRAINER SAFE BLADE—

MODEL 910T

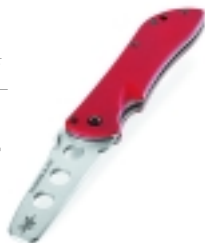

MODEL 910 STRYKER— Blade Material: 154CM Stainless Steel Hardened to 58-60HRC or M2 High Speed Steel Hardened to 60-62HRC; Length: 3.70" (9.40cm); Thickness: .125" (2.46mm); Open: 8.25" (20.96cm); Closed: 4.68" (11.89cm); Weight: 3.80oz (108gm); Handle: Black G10 Scales; Double Titanium Liners; Removable Steel Carry-Clip; Handle Thickness: 0.48" (1.20cm); Lock Mechanism: Modified Locking-Liner; Blade Style & Opener: Modified Tanto; Ambidextrous Thumb-Disk

Available Blade Configurations—

- **MODEL 910** ○ **MODEL 910S** ○ **MODEL 910SBT**
- **MODEL 910HS** ○ **MODEL 910HSSR** ● **MODEL 910T**

See inside back cover for listing of configurations and pricing.

MODEL 905 MINI-STRYKER— Blade Material: 154CM Stainless Steel Hardened to 58-60HRC; Length: 2.90" (7.37cm); Thickness: .100" (2.54mm); Open: 7.10" (18.03cm); Closed: 4.10" (10.41cm); Weight: 2.70oz (77gm); Handle: Black G10 Scales; Double Titanium Liners; Removable Steel Carry-Clip; Handle Thickness: 0.44" (1.11cm); Lock Mechanism: Modified Locking-Liner; Blade Style & Opener: Modified Tanto; Ambidextrous Thumb-Disk

Available Blade Configurations— ● **MODEL 905** ○ **MODEL 905S**

- **MODEL 905SBT** See inside back cover for listing of configurations and pricing.

BENCHMADE

MODELS 813 MINI-TSEK & 814 MINI-AFCK

Essential equipment in any world, this ergonomic tool design bends performance to fit your needs. ● Curved architecture allows the human hand to wrap it naturally with distinguishable comfort. ● And the higher standard of materials and manufacturing technologies will challenge you to push yourself harder. ● The world is full of surprises— don't make a failed knife one of them. 🦋

MODEL 813 MINI-TSEK— Blade Material: 440C Stainless Steel Hardened to 58-60HRC; Length: 3.16" (8.02cm); Thickness: .097" (2.46mm); Open: 7.62" (19.35cm); Closed: 4.46" (11.33cm); Weight: 3.10oz (88gm); Handle: Black G10 Scales; Double 410 Stainless Steel Liners; Movable Steel Carry-Clip; Handle Thickness: 0.42" (1.07cm); Lock Mechanism: Modified Locking-Liner; Blade Style & Opener: Modified Clip-Point; Thumb-Stud

Available Blade Configurations— ● **MODEL 813** ○ **MODEL 813S**

See inside back cover for listing of configurations and pricing.

MODEL 814 MINI-AFCK-II— Blade Material: 154CM Stainless Steel Hardened to 58-60HRC; Length: 3.25" (8.25cm); Thickness: .097" (2.46mm); Open: 7.65" (19.43cm); Closed: 4.40" (11.18cm); Weight: 3.00oz (85gm); Handle: Black G10 Scales; Double 410 Stainless Steel Liners; Movable Steel Carry-Clip; Handle Thickness: 0.42" (1.07cm); Lock Mechanism: Modified Locking-Liner; Blade Style & Opener: Modified Clip-Point; Ambidextrous Oval Thumb-Hole

Available Blade Configurations— ● **MODEL 814** ○ **MODEL 814S**

● **MODEL 814SBT** ● **MODEL 814SBTRT** ● **MODEL 814T**

See inside back cover for listing of configurations and pricing.

AMBIDEXTROUS OVAL THUMB-HOLE OR THUMB-STUD MAKE SINGLE-HAND FUNCTION A WELCOME REALITY

MODEL 814 MINI-AFCK



AVAILABLE WITH REALTREE® HARDWOODS®—

AVAILABLE WITH TRAINER SAFE BLADE—



MODEL 814SBTRT

MODEL 814T

MODEL 814SBT MINI-AFCK

MODEL 813S MINI-TSEK

**MODEL 335
BIG SPENDER**



THE SMOOTH STEEL HANDLE
SURFACE MAKES AN IDEAL
LOCATION FOR ENGRAVING

REFINED STYLING AND CONSERVATIVE
VIEWS ARE A REFRESHING BACKDROP
TO DRIVE INTEREST RATES UP

FUNCTIONAL HANDLE GROOVES
COMPLIMENT GRIP AND ADD
DISTINCTIVE ANGLES

MODEL 350S



MODEL 350SBT

PARDUE

MODEL 335 BIG SPENDER™ Consider it a fresh approach to financial security. ● Get a cut of the action with the compact utility blade design and its intelligent edge. ● A stainless steel structure offers good stability even with its small stature. ● And the money clip holds all bills no matter how large. 🦋

MODEL 335 BIG SPENDER— Designer: Pardue; Blade Material: 440C Stainless Steel Hardened to 58-60HRC; Length: 2.30" (6.30cm); Thickness: .070" (1.78mm); Open: 5.70" (14.48cm); Closed: 3.40" (8.64cm); Weight: 1.68oz (47gm); Handle: 410 Stainless Steel/Liners; Money-Clip; Handle Thickness: 0.21" (0.53cm); Lock Mechanism: Modified Locking-Liner; Blade Style & Opener: Clip-Point; Thumb-Stud

Available Blade Configurations— ● **MODEL 335**
See inside back cover for listing of configurations and pricing.

MODEL 350 A symmetry of design and balance assemble for maximum performance value. ● The sleek blade shape and slim, contoured handle coexist as an ultra-lightweight cutting tool. ● A stainless steel carry-clip holds the 350 in place until needed. 🦋

MODEL 350— Designer: Pardue; Blade Material: 154CM Stainless Steel Hardened to 58-60HRC; Length: 2.95" (7.50cm); Thickness: .088" (2.24mm); Open: 7.10" (18.00cm); Closed: 4.15" (10.50cm); Weight: 2.00oz (57gm); Handle: Molded Black Zytel; 410 Stainless Steel Liner; Handle Thickness: 0.37" (0.95cm); Lock Mech: Modified Locking-Liner; Blade Style & Opener: Spear-Point; Thumb-Stud

Available Blade Configurations— ● **MODEL 350** ● **MODEL 350S**
● **MODEL 350SBT** See inside back cover for listing of configurations and pricing.

BENCHMADE

ASCENT[®] II SERIES Good all around light-weight durability is here for the taking. ● Two blade styles employ the same premium grade steels used in more advanced models. ● Black handles are injection molded with a tactile surface and incorporate a lock-back for traditional two-handed function. ● A stainless steel carry-clip is screwed into stainless steel inserts, so it won't let go. 🦋

MODEL 824 MINI-ASCENT-II— Blade Material: 154CM Stainless Steel Hardened to 58-60HRC; Length: 2.90" (7.37cm); Thickness: .110" (2.80mm); Open: 6.95" (17.65cm); Closed: 4.00" (10.16cm); Weight: 1.80oz (51gm); Handle: Molded Black Zytel; Removable Steel Carry-Clip; Handle Thickness: 0.44" (1.11cm); Lock Mechanism: Rear-Lock Locking Back; Blade Style & Opener: Clip-Point; Ambidex. Oval Thumb-Hole

Available Blade Configurations— ● **MODEL 824** 🕒 **MODEL 824S**
🕒 **MODEL 824SBT** See inside back cover for listing of configurations and pricing.

MODEL 834 ASCENT-II— Blade Material: 154CM Stainless Steel Hardened to 58-60HRC; Length: 3.50" (8.89cm); Thickness: .115" (2.92mm); Open: 8.25" (20.96cm); Closed: 4.875" (12.38cm); Weight: 2.70oz (77gm); Handle: Molded Black Zytel; Reversible Steel Carry-Clip; Handle Thickness: 0.56" (1.16cm); Lock Mechanism: Mid-Lock Locking Back; Blade Style & Opener: Clip-Point; Ambidex. Oval Thumb-Hole

Available Blade Configurations— ● **MODEL 834** 🕒 **MODEL 834S**
🕒 **MODEL 834SBT** See inside back cover for listing of configurations and pricing.

MODEL 821 MINI-ASCENT-II UTILITY— Blade Material: 440C Stainless Steel Hardened to 58-60HRC; Length: 2.90" (7.37cm); Thickness: .110" (2.80mm); Open: 6.95" (17.65cm); Closed: 4.00" (10.16cm); Weight: 1.80oz (51gm); Handle: Molded Black Zytel; Removable Steel Carry-Clip; Handle Thickness: 0.44" (1.11cm); Lock Mechanism: Rear-Lock Locking Back; Blade Style & Opener: Clip-Point; Thumb-Stud

Available Blade Configurations— ● **MODEL 821** 🕒 **MODEL 821S**
See inside back cover for listing of configurations and pricing.

MODEL 831 ASCENT-II UTILITY— Blade Material: 440C Stainless Steel Hardened to 58-60HRC; Length: 3.40" (8.64cm); Thickness: .115" (2.92mm); Open: 8.25" (20.96cm); Closed: 4.85" (12.32cm); Weight: 2.70oz (77gm); Handle: Molded Black Zytel; Reversible Steel Carry-Clip; Handle Thickness: 0.56" (1.16cm); Lock Mechanism: Mid-Lock Locking Back; Blade Style & Opener: Clip-Point; Thumb-Stud

Available Blade Configurations—
● **MODEL 831** 🕒 **MODEL 831S**
See inside back cover for listing of configurations and pricing.

A LIGHTWEIGHT CARRY CONCEPT
WITH BIG TIME FEATURES TO TIP
THE SCALES OF PERFORMANCE

MODEL 834

MODEL 821S

MODEL 831

MODEL 824



BENCHMADE

SPECIAL PRODUCTIONS An infinite fusion of personal desires and fantasies into the matrix of Benchmade. Because we can. ● Just as time keeps moving, so do the creative minds and energies of Benchmade. ● Occasionally existing in-line models are modified or restyled for a totally different look or for enhanced value or even performance. Variants are limited in numbers and permanently marked to document their creation. ● The possibilities are unlimited, but the quantities are not. If you like to be different or appreciate an occasional collectible opportunity, frequent your favorite authorized Benchmade dealer or lock in on www.benchmade.com. 

MORE THAN KNIVES, THEY'RE AN
EXPRESSION OF FORM AND
FUNCTION. BOTH VISUALLY
AND EMOTIONALLY

MODEL 690-02

AUGUST 2002 • 500 PIECES

MODEL 710-01

JUNE 2002 • 300 PIECES

MODEL 941D2CF

AUGUST 2002 • 500 PIECES



MODEL 31-02

AUGUST 2002 • 25 PIECES

MODEL 960

NOVEMBER 2002 • 500 PIECES

PUSHING THE LIMITS OF
POSSIBILITIES WAY BEYOND
ALL EXPECTATION, AND THEY
LOOK PRETTY COOL, TOO

THE PLANET IS COVERED IN 70-PERCENT
WATER AND CHANCES ARE IT'S RAINING
SOMEWHERE IN THE OTHER 30-PERCENT.



**MODEL
100SH20-BLK**

**MODEL
100SH20**

SHEATH ATTACHES TO
PFD VIA A LASH-TAB
CLIP ASSEMBLY—

BENCHMADE

MODEL 100H2O NEW! A reality of performance fueled by the incessant exposure to liquid assets in an otherwise dry world for some. ● H1 steel is impervious to the elements and 100-percent corrosion resistant. ● Blade design is sharp enough to cut, yet blunt enough to be predictable. Partial serrations ravage rope or fibrous materials with ease. ● Handle slabs are machine sculpted to provide sufficient grip without overcrowding of space. ● Sheath design escalates performance to optimum levels with a unique three-point secure system and lash-tab clip attachment. ● Get out, get wet and release the amphibious urge! 🦋

MODEL 100H2O— Blade Material: H1 Stainless Steel Hardened to 58-60HRC; Length: 3.23" (8.32cm); Thickness: .114" (2.90mm); Overall: 7.50" (19.50cm); Weight: 4.00oz (128gm); Handle: Full-Tang; Fluorescent Yellow Kydex or Black G10 Scales; Handle Thickness: 0.58" (1.48cm); Sheath: Molded Kydex/Thermoplastic; Reversible Lash Tab Carry-Clip; Weight: 2.20oz (63gm); Blade Style: Modified Sheepfoot

Available Blade Configurations—

● **MODEL 100SH20** ● **MODEL 100SH20-BLK**

See inside back cover for listing of configurations and pricing.

BENCHMADE

MODELS 140 NIMRAVUS® & 145 NIMRAVUS CUB

A modern tip design towers like an obelisk in an endless spew of would-be challengers. ● Use of full-tang, premium grade steel blade consciously dissuades any fear of tool failure. ● Blade shape offers great utility. ● Uncompromised grip is achieved with sculpted G10 scales and an exposed tang enables blind indexing of the cutting edge. ● Sheath design is integral to a fixed blade knife and this one is no exception. A unique 3-point secure system holds the knife in its place. ● Two model sizes cover all application options. 🦋

MODEL 140 NIMRAVUS— Blade Material: 154CM Stainless Steel Hardened to 58-60HRC or M2 High-Speed Steel Hardened to 60-62HRC; BT2® Coated; Length: 4.50" (11.43cm); Thickness: .115" (2.92mm); Overall: 9.45" (24.00cm); Weight: 6.20oz (175gm); Handle: Full-Tang; Black G10 Scales; Handle Thickness: 0.58" (1.48cm); Sheath: Molded Kydex®/Thermoplastic; Movable Santoprene® Belt-Loop; Weight: 3.80oz (87gm); Blade Style: Modified Tanto

Available Blade Configurations—

- **MODEL 140BT**
- **MODEL 140SBT**
- **MODEL 140HS**
- **MODEL 140HSSR**

See inside back cover for listing of configurations and pricing.



MODEL 145 NIMRAVUS CUB— Blade Material: 154CM Stainless Steel Hardened to 58-60HRC; BT2® Coated; Length: 3.65" (9.27cm); Thickness: .115" (2.92mm); Overall: 7.82" (19.86cm); Weight: 4.00oz (128gm); Handle: Full-Tang; Black G10 Scales; Handle Thickness: 0.58" (1.48cm); Sheath: Molded Kydex®/Thermoplastic; Movable Santoprene® Belt-Loop; Weight: 3.80oz (87gm); Blade Style: Modified Tanto

Available Blade Configurations— ● **MODEL 145BT**
● **MODEL 145SBT** ● **MODEL 145SBTRT**

See inside back cover for listing of configurations and pricing.

AVAILABLE WITH REALTREE®
HARDWOODS®
(SHEATH MAY VARY)—



MODEL 145SBTRT



**MODEL 140HSSR
NIMRAVUS**

**MODEL 145BT
NIMRAVUS CUB**

—SHEATH COMES STANDARD
WITH BELT-LOOP;
OPTIONS AVAILABLE

A NON-THREATENING CONSERVATIVE
APPROACH TO AESTHETICS WITH INTELLIGENT
ACCRUEMENTS OF PERFORMANCE



**MODEL 180
OUTBOUNDER**

MC HENRY & WILLIAMS

MODEL 180 OUTBOUNDER® A refreshing retro to cutlery tradition with admirable modern overtones to enhance performance. ● The utility-generous blade shape flows into a custom quality taper-tang for optimum balance and blade control. ● Stabilized natural hardwood handle scales repel nature's elements and offer appreciable grip comfort. ● A stitched leather, deep pouch style belt-carry sheath is form fitted to caddy the 180 for the long haul. ● Get back to nature, get the Outbounder. 🦋

MODEL 180 OUTBOUNDER— Designers: McHenry & Williams; Blade Material: 440C Stainless Steel Hardened to 58-60HRC; Length: 3.75" (9.53cm); Thickness: .125" (3.18mm); Overall: 7.45" (18.92cm); Weight: 3.30oz (94gm); Handle: Full, Taper-Tang; Stabilized Hardwood Rose Color Scales; Handle Thickness: 0.56" (1.42cm); Sheath: Dyed Leather with Belt-Loop; Weight: 1.90oz (54gm); Blade Style: Drop-Point

Available Blade Configurations— ● **MODEL 180**
See inside back cover for listing of configurations and pricing.

BENCHMADE

MODELS 190 & 192 *NEW!* As a pair or individually, unmasking the elusive qualities needed to handle the diversity of tasks demanded of a knife in the outdoor world. ● A full, flat ground blade face gets plenty sharp everytime, and they're shaped for control, too. ● Sure handed hold is a reality with contoured stabilized hardwood shaped to fill the hand, and a pronounced finger guard leads the way. ● The stitched leather sheath with deep well pocket and snap-over strap is the real deal. ● Performance as big as all outdoors. Pack your gear...let's go! 🦋

MODEL 190 DROP-POINT HUNTER KNIFE –

Blade Material: 440C Stainless Steel Hardened to 58-60HRC; Length: 3.90" (9.91cm); Thickness: .125" (3.175mm); Overall: 8.00" (20.32cm); Weight: 4.50oz (128gm); Handle: Full-Tang; Contour Sculpted Stabilized Wood; Handle Thickness: 0.78" (1.98cm); Sheath: Stitched Leather with Belt Loop; Color Dyed; Snap Over Strap; Weight: 1.00oz (28gm); Blade Style: Drop-Point

Available Blade Configurations – ● **MODEL 190**

See inside back cover for listing of configurations and pricing.

MODEL 192 BIRD & TROUT KNIFE –

Blade Material: 440C Stainless Steel Hardened to 58-60HRC; Length: 3.94" (10.00cm); Thickness: .080" (2.03mm); Overall: 8.00" (20.32cm); Weight: 2.80oz (79gm); Handle: Full-Tang; Contour Sculpted Stabilized Wood; Handle Thickness: 0.67" (1.70cm); Sheath: Stitched Leather with Belt Loop; Color Dyed; Weight: 1.00oz (28gm); Blade Style: Bird & Trout

Available Blade Configurations – ● **MODEL 192**

See inside back cover for listing of configurations and pricing.

THE IDEAL KNIFE INGREDIENTS AND INTELLIGENT OUTDOOR DESIGN FEATURES MELD AS ONE



**MODEL 190
DROP-POINT
HUNTER**

**MODEL 192
BIRD & TROUT**

NO POCKETS?
NO PROBLEM.



**MODEL 160S
TK-1**

**MODEL 160SBT
TK-1**

TACTILE HANDLE COATING
INCREASES GRIP AND SHIELDS
YOU FROM EXPOSED METAL
WHILE WEARING (Br...)

—OPTIONAL LASH-TAB
CLIP ASSEMBLY KIT
AVAILABLE SEPARATELY



PART #981607

MODEL 160 TK-1 TETHER KNIFE An active exercise in creative carry, or is it a creative exercise in active carry? Either way, it works. ● A single-piece skeletonized steel architecture is both blade and handle. Big enough to be useful, small enough to stay out of the way. ● The ultra-thin, organic sheath design is anatomically friendly and holds the knife secure. ● Standard model employs an effective break-away tether just in case. ● Around the neck, around your active world— an alternate approach to knife carry. 🦋

MODEL 160 TETHER KNIFE — Blade Material: 440C Stainless Steel Hardened to 58-60HRC; Length: 2.00" (5.08cm); Thickness: .125" (3.18mm); Overall: 5.75" (14.50cm); Weight: 1.50oz (42gm); Handle: Skeletonized Full-Tang; Black Thermal Plastic Coating; Handle Thickness: 0.18" (0.45cm); Sheath: Molded Kydex®/Thermoplastic; Weight: 1.00oz (28gm); Blade Style: Modified Utility

Available Blade Configurations— ● **MODEL 160** ● **MODEL 160S**
● **MODEL 160SBT** See inside back cover for listing of configurations and pricing.



—DETAIL OF BREAK-AWAY
LANYARD CLASP; REUSABLE
OVER AND OVER

BENCHMADE

MODEL 5 RESCUE HOOK So many uses... *SO FAST!* ● Form and function collide with the deftness to save time, save effort and ultimately save lives. ● Readily slice through security belts, rope, clothing and a multitude of fibrous or pliable matter with light-speed quickness. ● A scalpel sharp edge is shrouded from inadvertent exposure to your surroundings. ● Positive grip is at the ready even gloved, with aggressive treads along the tool spine. ● Put one in your world and get hooked for safety. 🦋

MODEL 5 RESCUE HOOK— Blade Material: 420HC Stainless Steel Hardened to 54-58HRC; Blade Opening: 0.50" (1.27cm); Overall Length: 2.90" (7.37cm); Thickness: .113" (2.87mm); Weight: 1.20oz (34gm); Handle: Finger Hole 1.12" (2.85cm); Soft Sheath: Nylon Webbing Pouch/Velcro Closure; Weight: 0.60oz (17gm); Hard Sheath: Molded Delrin® Snap-Fit (Varied Carry Options Available); Weight: 0.60oz (17gm)

Available Blade Configurations— ● **MODEL 5** ● **MODEL 5BLK** ● **MODEL 5W**
● **MODEL 5 BLKW** See inside back cover for listing of configurations and pricing.

—CUTS QUICKLY, SAFELY
AND EFFECTIVELY
WITH PULLING MOTION



PART
#981607

MODEL 5W
SOFT SHEATH



OPTIONAL LASH-TAB
CARRY CLIP ASSEMBLY
— AVAILABLE SEPARATELY

TWO SHEATH STYLES
OFFER VERSATILE CARRY

THE RESCUE HOOK DESIGN INCORPORATES AN OXYGEN VALVE-WRENCH (FOR EMT USE), FINGER-HOLE BOTTLE OPENER, AND LANYARD HOLE TO MAXIMIZE UTILITY



MODEL 5BLK

MODEL 5

MODEL 5BLK
HARD SHEATH

RESPONSIBLE INNOVATION
AND THE REPUTATION TO
BACK IT UP

MODEL 43
BOWIE

— **MODEL 47**
TANTO

MODEL 42
WEEHAWK

SPRING-LATCH
ON ALL STANDARD
40 SERIES MODELS

MODEL 46
SPEAR

NEW!
MODEL 42SS
STAINLESS STEEL HANDLES

PRACTICE MAKES
PERFECT (AND SAVES
BAND-AIDS®) —

NEW!
MODEL 40TR

MODEL 40T

BENCHMADE

MODELS 42, 43, 46, 47 BALI-SONG®

Various shapes of steely blades move freely through a kinetic motion of human manipulation and offer great utility. ● **NEW! MODEL 42SS** stainless steel or cast titanium handles are skeletonized for grip and precision tuned for performance. ● Oversized, hardened steel pivot-pins are pressed and threaded to keep assemblies tight. ● An innovative spring action latch system opens quickly and stays out of the way. ● Unrivaled craftsmanship and polished innovation are a reflection of all that is Bali-Song. 🦋

MODEL 42, 43, 46 & 47 BALI-SONG— Blade Material: 440C Stainless Steel Hardened to 58-60HRC; Length: 4.20" (10.67cm); Thickness: .125" (3.18mm); Overall: 9.40" (23.88cm); Closed: 5.20" (13.21cm); Weight: 4.10oz (116gm); Handle: Skeletonized Cast 6AL-4V Titanium; Handle Thickness: 0.51" (1.30cm); Lock: Integrated Spring Latch; Blade Style: Various; Sheath: Soft Cordura®; Belt Carry

Available Blade Configurations— ● **MODELS 42, 43, 46 & 47** ● **MODEL 42S**
See inside back cover for listing of configurations and pricing.

NEW! MODEL 42SS (STAINLESS STEEL) BALI-SONG— Blade Style And Dimensions Same As Model 42 With These Exceptions: Weight: 7.80oz (221gm); Handle: Skeletonized Cast Stainless Steel

Available Blade Configurations— ● **MODEL 42SS**
See inside back cover for listing of configurations and pricing.

MODEL 40T & 40TR TRAINERS— Same Size, Weight And Balance As Titanium Model 40 Series; Skeletonized Trainer Safe Blade

Available Blade Configurations— ● **MODEL 40T** ● **MODEL 40TR**
See inside back cover for listing of configurations and pricing.

BENCHMADE

BORN OF HISTORY AND TRADITION

Awesome in simplicity. Purity in form and function. As much an art form as it is a cutting tool. Raw steel, molten titanium, the occasional exotic inlay, and American ingenuity are put into motion. A motion so smooth, so fluid and so tight there can be no mistake, it's an original— it's a Benchmade. More than a livelihood, it's a passion. It's personal. ● The roots run deep and the pride burns strong. Bali-Song and the butterfly are a much a part of Benchmade as the name itself. ● Others may aspire to imitate, but unless it has the butterfly signature on the blade— it isn't a real Bali-Song®. 🦋



BENCHMADE

SLIM, LOW-PROFILE
CARRY-CLIP ENABLES
CONVENIENT CARRY

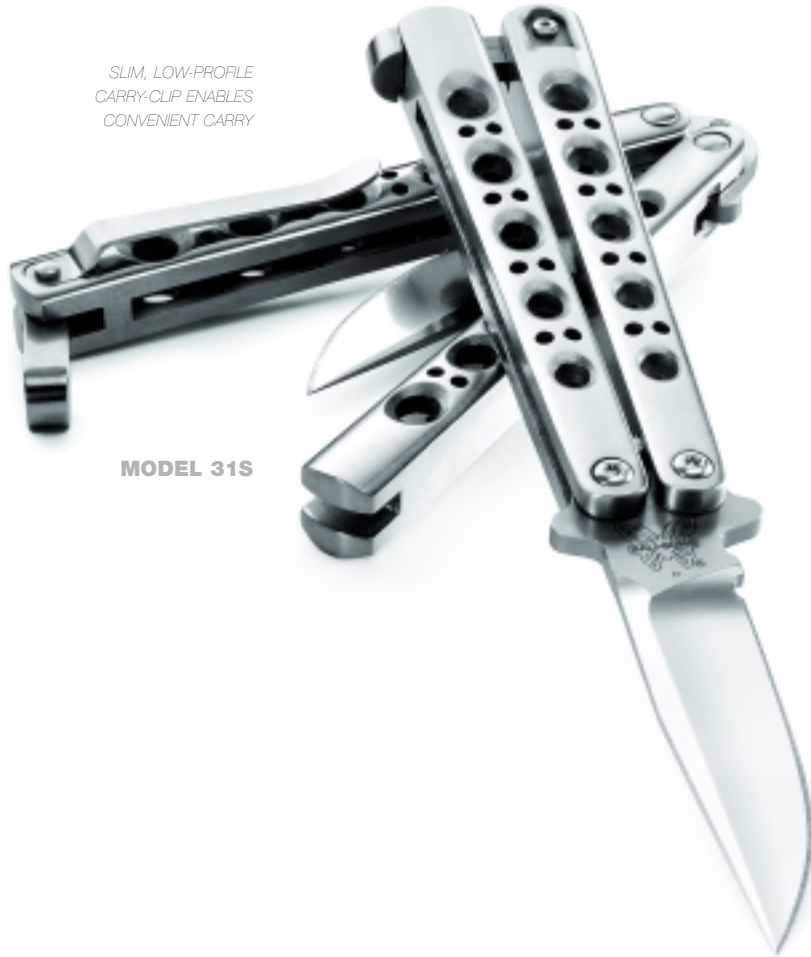

MODEL 31S

SKELETONIZED, MIM TITANIUM
HANDLES DELIVER FREE-
WHEELING SPEED OF MOTION

MODEL 31

MODEL 31 BALI-SONG® Technically a Bali-Song, but don't be fooled it makes a great every-day pocket carry knife, too. ● A clipped-utility blade shape is generous on performance and like all true Bali-Songs, it features the authentic signature butterfly laser burned into its steel. ● Lightweight, skeletonized handle forms are MIM titanium and swing-latched for solid lock-up. A latch-gate in the handle prevents latch and blade from colliding. ● The reversible carry-clip is a nice addition for convenient carry. ● For a different spin on a butterfly, or just for a great knife, the 31 gets it done Benchmade style. 🦋

MODEL 31 BALI-SONG— Blade Material: 440C Stainless Steel Hardened to 58-60HRC; Length: 2.98" (7.57cm); Thickness: .125" (3.18mm); Overall: 7.09" (18.01cm); Closed: 4.35" (11.05cm); Weight: 3.10oz (88gm); Handle: Skeletonized MIM Titanium; Reversible Carry-Clip; Handle Thickness: 0.51" (1.30cm); Lock: Integrated Titanium Latch; Blade Style: Clipped Utility

Available Blade Configurations— ● **MODEL 31** ● **MODEL 31S**
See inside back cover for listing of configurations and pricing.

BENCHMADE

PRESTIGEDGES™ NEW! An edge so telling it's in the name (*pronounced "prestigious"*) are nothing less than a redefinition of the finest in kitchen cutlery. ● A throwback to purity of design and yet fashioned with a progressive appreciation of modern age materials and technologies for their premium performance qualities. ● From arguably the finest cutting edge available anywhere in the world today to the custom qualities of classic elegance in visual and functional detail. ● The best of the best for a culinary experience that's the epitome of *"the essence of edge"*. Prestigedges. 🦋

PRESTIGEDGES— Blade Material: Single Piece, Full-Tang 440C Stainless Steel Hardened to 58-60HRC; Handle: Impregnated Real Wood Laminate; Woven Micarta Bolster; Nickel/Silver Rivet Assembly

3-KNIFE SET COMES IN ATTRACTIVE PRESENTATION CASE —



PARING KNIFE— Blade Length: 3.50" (8.89cm); Thickness: .0725" (1.84mm); Overall Length: 7.09" (18.01cm); Weight: 2.10oz (60gm)

UTILITY KNIFE— Blade Length: 6.00" (15.24cm); Thickness: .120" (3.05mm); Overall Length: 10.25" (26.04cm); Weight: 4.80oz (136gm)

CHEF KNIFE— Blade Length: 8.00" (20.32cm); Thickness: .1415" (3.59mm); Overall Length: 13.00" (33.00cm); Weight: 8.50oz (241gm)

Available Configurations— ● **3-Knife Set**
See inside back cover for listing of configurations and pricing.

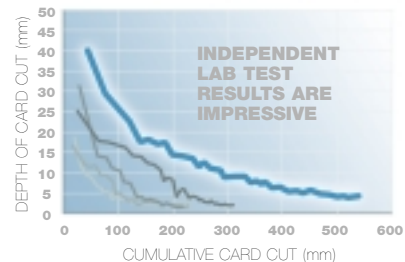

BLADES ARE PRECISION LASER CUT FROM A SINGLE PIECE OF STEEL AND FULL-TAPER GROUND FOR THE ULTIMATE EDGE

CHEF KNIFE

8-INCH



PARING KNIFE

3.50-INCH

UTILITY KNIFE

6-INCH

KNIVES SO SHARP, SO NICELY BALANCED, AND SO UNIQUELY SUPERIOR THROUGH AND THROUGH

BEYOND THE EDGE

THE MACHINE

What do you get before a machine ever starts. Whether it's members or developing Benchmade's own

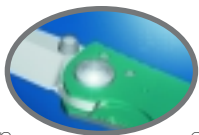

when you make the choice of Engineering Department hell working closely with one of designs, our engineers are contin-



Benchmade? Rocket scientist on getting it right—our Custom Design Team usually checking and rechecking



for perfection. With a Benchmade, each piece is its own individual manufacturing process which must assemble as a "go together" finished knife. From the latest computer aided design software and modeling technologies to just plain know-how gained from years of experience, it's a test of wills. And the customer always wins. ● The Benchmade arsenal contains ultra-modern machining centers capable of spot-on prototyping designs prior to production. Highly skilled machinists are capable of hitting tolerances as tight as .0005 of an inch if needed. ● It's lot of effort for just a knife. Which is exactly why Benchmade knives aren't "just a knife"... they're engineered cutting tools built to exacting standards with a fierce determination of purpose, form and function. Yours. 🦋

THE INGREDIENTS

What's it made of? What is that black stuff on the handle? Which blade steel is best? These are just a few of the many questions we are asked when people see our knives, and they basically come down to one common denominator... Benchmade uses a variety of modern materials specially selected for their superior performance characteristics— regardless of their manufacturing difficulty. ● We strongly believe that if you're going to put so much effort into designing a custom quality knife, then it only makes sense to build it of the materials which compliment its form and enhance its function. And in some instances it's more than just using a superior material in a product— it's what we do to it to bring out the extra edge which makes a Benchmade that much better in performance. Bottom line— we would much rather overbuild our knives than risk the alternative. You're welcome. ● *Following is a Benchmade materials list with a brief description of the component material characteristics and some of the special processes we use.* 🦋

LINERS

6AL-4V TITANIUM A slightly lighter weight, modern metal offering incredible strength and resiliency. Key properties include non-magnetic and corrosion resistance. We laser cut to form and machine finish to final spec. **410 STAINLESS STEEL** An ideal 400 Series steel offering good corrosion resistance and workability. We laser cut material to form, machine finish to spec and heat-treat for optimum performance strength.

HANDLES

CARBON FIBER A modern age, very "proprietary" make-up of alternating woven layers of carbon strands and epoxy which provides exceptional strength to weight ratios. And it looks pretty hot too. **STABILIZED WOOD** Select hardwood veneers are vacuum impregnated with special dyes and resins. Sheets are then layered and pressured under tremendous heat and pressure. This process creates a fashionable, stabilized real wood medium for a durable and attractive composite. **6061 T-6 ALUMINUM** Originally developed as a premium aircraft grade aluminum which is aged to a T-6 temper for improved toughness. We precisely machine to spec, bead blast for texture and then anodize with hard oxide coating for enhanced grip and "wearability." **G10** Developed as an aerospace material able to withstand extreme conditions without distortion or negative effect. Impervious to moisture or liquid, for ideal outdoor toughness. *(cont'd next page...)*

G10 *cont'd* A highly compressed epoxy and woven glass composite providing nearly indestructible strength and is of nominal weight. We laser cut and machine finish to final spec. Benchmade uses black, and was the first manufacturer to utilize multi-color layered G10 for a unique visual effect. **NORYL GTX®** A modern engineered plastic offering high-strength, minimal flex and optimally lightweight properties. We use a 30% glass fill mix for great all around qualities. **VALOX®** A reinforced resin with excellent stiffness, strength and dimensional stability. We use it in the molded colored handles. **ZYTEL®** A lightweight glass filled nylon, engineered for strength and durability while still offering moldable versatility. It's widely used in the automotive industry in engine related components. For our purpose, the molded handles offer lightweight, durable performance at an inherently economical value to you. **KYDEX®** A proprietary acrylic/PVC exhibiting outstanding impact resistance, chemical resistance and fire retardancy. Good outdoor weatherability. For our application, the injection molded sheaths offer lightweight, durable performance at an inherently economical value to you.

BLADE STEELS & FINISHES

154CM STAINLESS STEEL USA made by Crucible Steel. Developed for use in high performance bearings for aerospace applications. A special forging and rolling process gives it a super-fine grain structure which translates well for excellent lasting edge sharpness. We temper it to a Benchmade "custom" toughness which has proven to offer you higher than average blade strength. **NEW! S30V STAINLESS STEEL** A specially developed Crucible steel specifically for knives. Much easier to process and it develops superior properties when heat-treated. Equal to or better than 440C in corrosion resistance with superior edge quality. **D2 TOOL STEEL** Similar to 440C with higher carbide volume resulting in superior edge retention.



COMMON BLADE STEELS

STEEL	CARBON	CHROMIUM	COBALT	COPPER	MAGANESE	MOLYBDENUM	NICKEL	PHOSPHOROUS	SILICON	SULPH	TUNGSTEN	VANADIUM	HRC
154CM	1.05	14.00	-	-	0.50	4.00	-	-	0.30	-	-	-	58-60
ATS-34	1.05	14.00	-	-	0.40	4.00	-	0.03	0.35	0.02	-	-	58-60
S30V	1.45	14.00	-	-	-	2.00	-	-	-	-	-	4.00	58-60
GIN-1	0.90	15.50	-	-	0.60	0.30	-	0.02	0.37	0.03	-	-	58-60
H-1	0.12	14.20	-	-	1.00	1.00	6.80	0.015	3.50	0.001	-	-	58-60
M-2	0.95-1.05	3.75-4.50	-	-	0.15-0.40	4.75-6.50	0.30	-	0.20-0.45	-	5.00-6.75	2.25-2.75	60-65
D-2	1.40-1.60	11.00-13.00	-	-	0.60	0.70-1.20	0.30	-	0.60	-	-	1.10	57-61
425 MOD.	0.40-0.54	13.50-15.00	-	-	0.50	0.60-1.00	-	0.035	0.80	0.03	-	0.10	56-60
440A	0.65-0.75	16.00-18.00	-	-	1.00	0.75	-	0.04	1.00	0.03	-	-	55-57
440C	0.95-1.20	16.00-18.00	-	-	1.00	0.75	-	0.04	1.00	0.03	-	-	58-60
AUS-8	0.70-0.75	13.00-14.50	-	-	0.50	0.10-0.30	0.49	0.04	1.00	0.03	-	0.10-0.26	58-59
AUS-10	0.95-1.10	13.00-14.50	-	-	0.50	0.10-0.31	0.49	0.04	1.00	0.03	-	0.10-0.27	59-60
ATS-55	1.00	14.00	0.40	0.20	0.50	0.60	-	-	0.40	-	-	-	60-62
BG-42	1.15	14.50	-	-	0.50	4.00	-	-	0.30	-	-	1.20	61-63
CPM(T)440V	2.15	17.00	-	-	0.40	0.40	-	-	0.40	-	-	5.50	55-57
CPM 3V	0.80	7.50	-	-	-	1.30	-	-	-	-	-	2.75	58-60
SNDVK120C	-	14.00-14.50	-	-	0.35	-	-	-	0.35	-	-	-	54-56

To help you better understand the science of steel, we offer an overview of some of the commonly used steels in knife making. Steel is made of iron and carbon in different combinations. When heated to certain temperatures and then cooled down at specific rates, it changes the properties of the metal. By starting with premium steels and employing custom heat-treat practices, Benchmade knives excel in all areas of performance.

M2 HIGH-SPEED STEEL A very tough, tool grade steel used as cutting steel and offering high abrasion/wear resistance. Offers high-impact strength with incredible edge holding properties. Non-stainless by nature, so we heat-treat and apply our proprietary BT2® coating which provides a high-level of corrosion resistance. **BC1™ COATING** (Boron Carbide) An extremely hard, thin ceramic coating applied in a vacuum chamber. Its extreme hardness and excellent adhesion provide wear resistance and lubricity while creating an attractive visual distinction in the process. **BT2® COATING** Our own proprietary blade coating is a black Teflon® based polymer offering corrosion protection which exceeds the ASTM-117 specification for saltwater corrosion resistance. Its high lubricity also improves knife function. **COMBOEDGE™** Refers to our partially serrated plain blade configuration. Benchmade's serration pattern offers ideal cutting ability for fibrous materials such as webbing, straps, netting or rope. **HEAT-TREATMENT** We specially heat-treat our blade steels to a "custom toughness" for Benchmade superior performance. ● Refer to our website at www.benchmade.com for the most current information on Benchmade's manufacturing processes and materials. 

SPECIAL SERVICES

PERSONALIZED LASER MARKING — Show the pride. Make it yours. Commemorate an event or outfit the club. Whatever the circumstance, now you can have your logo or artwork laser etched onto any of the Benchmade knives. The etched mark becomes a permanent signature on the knife in the same way we brand the knives with the Benchmade logo. ● Depending on the particular model, the mark can be placed either on the blades, or in some models, on the handles. All it takes is a clean, black and white representation of your logo or artwork, and we can take it from there. ● If you are interested in this special service, simply call a Benchmade customer service representative at **800.800.7427**. *Basic set-up charges and quantity restrictions do apply.*



LIFESHARP® SERVICE — There's never a dull moment with a Benchmade... That's right! We will gladly sharpen your Benchmade knife to a factory razor sharp edge (service does not apply to any serrated portion of the blade). If you prefer us to sharpen your blade, or if you may have neglected to maintain your edge for a while, simply ship your knife to us. We'll not only sharpen it, but we will also inspect the knife for any warranted repairs and "tune" the knife for optimum performance. ● Simply ship the knife to the Benchmade address, postage paid and insured. Please enclose your return shipping address with \$5.00 to cover return shipping charges.

ACCESSORIES



THE BLUE BOX — Benchmade uses "six-lobe" headed screws exclusively throughout the assembly of our knives. This unique screw style offers a more "controllable" means of achieving tightness. Occasionally you may want to adjust blade tension, remove the carry-clip or simply check for any loosened screws, so now we offer this handy kit for those purposes. Kit includes bit sizes 6, 7, 8, 10, 15, one phillips head bit and bit holder/extension all self-contained in a molded plastic case which doubles as the handle. Features removable plastic carry-clip on case. **PART NUMBER 981084**...\$12



SOFT SHEATHS — For those individuals who prefer to carry their knives in a sheath we offer a simple but effective design which is available in several sizes. There are two different sizes (small- 1.625" W x 5.00" D; large- 2.00" W x 5.25" D) for folders and one for a 4-inch Bali-Song (*not pictured*). ● All soft sheaths are made of 1680 denier poly-ballistic nylon with liners and they are edged with nylon for a clean, no-snag finish. They feature Velcro® closures. **PART NUMBER 981086** small; **981087** large...\$10/ea.

MILITEC-1® — It's what we use to lubricate all Benchmades. A "chemically-reacted synthetic-based metal conditioner that protects metal with a constant synthetic-based impregnated molecular structure." Simply put, it delivers constant lubrication; reduces friction and wear; inhibits corrosion; and causes no unwanted material buildup. Works great on knives and many other metal-to-metal situations. *See price list for available options and pricing.*

SHEATH CARRY ACCESSORIES — We offer several sheath carry accessories so you can modify your Benchmade sheaths to better suit your particular carry needs. These include: **A** Metal-clip w/lash tab; **B** Molded belt loop with bridge/hardware; **NOT PICTURED:** Tek-Lok® and Perma-Clips®; individual Lash tabs; and Carry-Strap w/lash tab. (NOTE: Some items are limited to model specific applications). See *price list for complete listing, specs and pricing.*



BRANDED SPECIALTY ITEMS

Show 'em Your True Colors!— If you're a Benchmade fan you will definitely want to checkout the selection of items emblazoned with your brand of choice. All specially selected items to ensure your satisfaction in getting quality products. After all, we like to enjoy them, too! Order direct from Benchmade (*please specify sizes*), or see your Benchmade dealer. Checkout www.benchmade.com for the complete and most current lof offerings which changes throughout the year.

BENCHMADE KNIFE ATTACHE— *VERY NICE!* Now you can keep all those Benchmades in one place... This soft carry-case holds up to 12 folders. Its shell is constructed of a heavyweight denier and is stitched plenty strong for lasting wear. A deep plush interior lining ensures scratch-free storage. ● A total of twelve, 1.50 x 5-inch pockets, with six pockets featuring a split-window for easier small knife retrieval. ● Velcro® flap closure holds everything in place, and proudly displays the Benchmade name embroidered on its face. **PART NUMBER 981456**...\$35



CERAMIC MUG— This oversize 15-ounce mug is sure to make any beverage taste better... Well ok, at least look better. Cruise around the office or the house with your knife intelligence in full view for all to envy. ● Mugs are glossy black color with Benchmade logo in blue and have a beefy handle for you "heavy" drinkers. **PART NUMBER 981127**...\$10/ea.



Use your head... GRIPTILIAN CAP & BLUE PRO CAP— Contain those extra brain waves from escaping your head. Both caps are unstructured lightweight style with buckle/strap closures. Griptilian cap features Griptilian logo embroidered in color on front with "Get A Grip!" sewn in black on back. Pro cap features Benchmade butterfly logo embroidered in black and silver on the front facing along with "HELD TO A HIGHER STANDARD" stitched in silver over the buckle/strap closure. Adjustable, one size fits most all. **PART NUMBER 981690 (Griptilian) & 981332 (Blue Cap)**...\$15/ea.





B



C



SILVER GIFT BOX INSERTS

981480	Model 335/blue insert	\$1
981481	Model 690/blue insert	\$1
981483	Model 770/blue insert	\$1
981613	Model 4" Bali Song/light gray insert	\$1
981614	Model 3" Bali Song/light gray insert	\$1
981615	Model 705/light gray insert	\$1
981616	Model 940/light gray insert	\$1
981618	Model 720/light gray insert	\$1
981620	Model 730/light gray insert	\$1

A NYLON JACKET— This two-toned blue, vented back jacket is great as a layered outer shell or just to wear by itself. Water repellent, wind resistant, double layer nylon body with mesh lining. The Benchmade logo is embroidered on the left chest in black and silver stitching. Full-zipper front with flapped pockets. Sizes are S - 2XL. **ITEM: BLUE JACKET** ...\$60

B POLAR FLEECE VEST— Perfect for those days when it's not too cold and it's not too hot— it's just right. That's exactly when this quality charcoal grey, fleece vest earns its colors. Speaking of colors, the Benchmade logo is embroidered on the left chest in blue and silver stitching. Full-zip front/zip pockets. Black trim. Sizes are S - 2XL. **ITEM: GRAY VEST** ...\$60

C BLACK JACKET— Due to popular demand we brought it back... Features a soft-lined, flat black nylon shell to keep you warm on those brisk mornings out and about. The Benchmade logo is quality embroidered on the left chest in metallic blue and silver stitching. Zip pockets help to keep things in their place, too. Sizes are S - 2XL. **ITEM: BLACK JACKET** ...\$75

SILVER GIFT BOXES— Over the years, the Benchmade blue paper boxes have become quite the status symbol worldwide. And now you can get these special presentation boxes for gift giving or display. ● These are formed metal boxes with the Benchmade logo proudly embossed into the lid (*spring hinge*), satin lined and match with model specific tray inserts. All boxes are shipped in protective chip-board slip cover. *Please specify/order tray insert with boxes, see part number listing.* **SILVER BOX PART NUMBER 981485** ...\$10/ea. (Box + Insert)

NOTICE: Check the website for a complete showing of branded clothing/specialty items which are not in the catalog. New items are added throughout the year.

THE ULTIMATE SOURCE

THE WEBSITE— Write it down. Bookmark it. Frequent it. It's your direct link to everything that's Benchmade. Complete product listing, technical information, mechanism demos and fresh product releases. ● The Benchmade Forum gives you the opportunity to exchange information with other Benchmade fans all over the world. Read up on user reviews to get first hand opinions. ● Find out if Benchmade will be attending trade shows in your area. ● Send us an email to ask a question or let us know how our products are doing. The "door" is always open. **ORDER BENCHMADE ONLINE!**— Too busy to get out, or can't find the model you want locally? Order it online direct from the factory and have it shipped to you. It's convenient, fast and secure way to get it when you... "gotta have it now". **GO TO www.benchmade.com!** 

Every effort is made to ensure the accuracy of this price list and information presented here. However, we reserve the right to rectify any and all errors prior to any sale transactions. Color indicates **NEW!** product for 2003 catalog. This catalog is produced annually. Check website for the latest information.

Prices shown are at suggested retail (U.S. currency), actual purchase prices may vary. All pricing and product specifications are subject to possible change without prior notice.

MODEL FEATURE CODES

These codes appear after the Benchmark model specific numbers. They identify particular feature variations within each model. (Example- Model 140SBT is a Model 140 knife which features partially serrated ComboEdge and BT2 Teflon coating on the blade).

(NO CODE)	Plain edge/no blade coating
S	ComboEdge, partially serrated/no blade coating
BT	Plain edge/BT2 black color Teflon coated blade
SBT	ComboEdge, partially serrated/BT2 black Teflon coated blade
BC1	Plain edge/BC1 charcoal color Boron Carbide coated blade
SBC1	ComboEdge/BC1 charcoal color Boron Carbide coated blade
FS	Fully-serrated edge/no blade coating
FSBT	Fully-serrated edge/BT2 black color Teflon coated blade
D2	D2 steel , BT2 black color Teflon coated blade
HS	M2 steel , plain edge/BT2 black color Teflon coated blade
HSSR	M2 steel , ComboEdge/BT2 black color Teflon coated blade
SBTRT	ComboEdge/BT2 black color Teflon coated blade Realtree Hardwoods camo-patterned handle
T	Trainer blade
PUR	Purple color handle
GRN	Green color handle
YEL	Yellow color handle
BLU	Blue color handle
OD	Olive Drab color handle
A	Plain edge/anodized color handle
AS	ComboEdge/anodized color handle
SS	Stainless Steel

ITEM NUMBER	BLADE & HANDLE STYLE DESCRIPTION	SUGGESTED RETAIL
MODEL 5 RESCUE HOOK		
5 W	Satin finish w/ soft sheath	\$25
5 BLKW	Black Oxide finish w/ soft sheath	\$25
5	Satin finish w/ molded snap-fit hard sheath w/ tether	\$35
5 BLK	Black Oxide finish w/molded snap-fit hrd shth w/ tether	\$35
981605	Molded snap-fit hard sheath w/ tether	\$10
981606	Molded snap-fit hard sheath w/ metal clip	\$15
981607	Metal clip kit w/ lash tab	\$15

Specifications— 0.50" Blade opening. Thickness: .113"; Overall length: 2.90"; Weight: 1.20 oz.; 420HC stainless steel (56-58HRC) satin finish or Black Oxide; Sheath Options: 1. Soft nylon web pouch with velcro closure; 2. Snap-fit molded hard plastic

MODEL 100 R & R (RIVER & RESCUE)

100SH20	Fixed blade/ComboEdge/yellow handle/sheath	\$95
100SH20-BLK	Fixed blade/ComboEdge/black handle/sheath	\$95

Specifications— 3.23" Blade. Thickness: .114"; Overall length: 7.50"; Weight: 4.0oz; Full tang blade; H1 stainless steel (58-60 HRC), Sculpted bright yellow Kydex or black G10 handle; Sheath: Weight: 2.20oz; Material: Molded Kydex/thermal plastic

MODEL 140 NIMRAVUS

140BT	Fixed blade/plain edge/BT2 coating, sheath	\$155
140SBT	Fixed blade/ComboEdge/BT2 coating, sheath	\$155
140HS	M2 steel/fixed blade/plain edge/BT2 coating, sheath	\$165
140HSSR	M2 steel/fixed blade/ComboEdge/BT2 coating, sheath	\$165

Specifications— 4.50" Blade. Thickness: .115"; Overall length: 9.45"; Weight: 6.20oz; Full-tang blade; 154CM stainless steel model (58-60 HRC), M2 high-speed steel model (60-62 HRC), Sculpted black G10 handle; Molded Kydex® sheath; Weight: 3.80oz

MODEL 145 NIMRAVUS CUB

145BT	Fixed blade/plain edge/BT2 coating, sheath	\$140
145SBT	Fixed blade/ComboEdge/BT2 coating, sheath	\$140
145SBTRT	154CM/ComboEdge/BT2/Realtree Hardwoods, sheath	\$160

Specifications— 3.65" Blade. Thickness: .115"; Overall length: 7.82"; Weight: 4.00oz; Full-tang blade; 154CM stainless steel model (58-60 HRC), Sculpted black G10 handle; Molded Kydex® sheath; Weight: 3.80oz

MODEL 160 TETHER KNIFE

160	Fixed blade/plain edge/black handle, sheath	\$60
160S	Fixed blade/ComboEdge/black handle, sheath	\$60
160SBT	Fixed blade/ComboEdge/BT2 coating/blk hndl, sheath	\$70

Specifications— 2.00" Blade. Thickness: .125"; Overall length: 5.75"; Weight: 1.50oz; Full tang blade; 440C stainless steel(58-60HRC), Black Thermal plastic coated handle; Sheath: Weight: 1.00 oz.; Material: Kydex® with two-piece break-away tether.

MODEL 180 OUTBOUNDER

180	Fixed blade/plain edge/Rosewood hndl/leather sheath	\$100
------------	---	-------

Specifications— 3.75" Blade. Thickness: .125"; Overall length: 7.45"; Weight: 3.30oz; Full tang blade; 440C stainless steel (58-60 HRC), Taper-tang, stabilized hardwood rose color handle; Sheath: Weight: 1.90 oz.; Material: Dyed natural leather

ITEM NUMBER	BLADE & HANDLE STYLE DESCRIPTION	SUGGESTED RETAIL
MODEL 190 (DROP POINT HUNTER)		
190	Fixed blade/plain edge/Hardwood hndl/leather sheath	\$100
Specifications— 3.90" Blade. Thickness: .125"; Overall length: 8.00"; Weight: 4.50oz; Full tang blade; 440C stainless steel (58-60 HRC), stabilized hardwood handle; Sheath: Weight: 1.00 oz.; Material: Dyed natural leather		
MODEL 192 (BFD & TROUD)		
192	Fixed blade/plain edge/Hardwood hndl/leather sheath	\$100
Specifications— 3.94" Blade. Thickness: .084"; Overall length: 8.00"; Weight: 2.80oz; Full tang blade; 440C stainless steel (58-60 HRC), stabilized hardwood handle; Sheath: Weight: 1.00 oz.; Material: Dyed natural leather		

MODEL 310 BENCHMARK

310	Plain edge/satin finish blade, titanium handle scales	\$100
------------	---	-------

Specifications— 1.92" Blade. Thickness: .084"; Overall length: 4.75"; Closed: 2.85"; Weight: 1.00oz; 154CM stainless steel blade hardened to (58-60 HRC), Blue color anodized titanium liners/scales; LEVITATOR™ lock mechanism

MODEL 335 BIG SPENDER

335	Plain edge/satin finish blade, stainless steel hndl scales	\$75
------------	--	------

Specifications— 2.30" Blade. Thickness: .070"; Overall length: 5.70"; Closed: 3.40"; Weight: 1.68 oz; 440C stainless steel blade hardened to (58-60 HRC), Double 410 stainless steel liners/scales; Money-clip.

MODEL 350 (PARDUE)

350	Plain edge/satin finish blade, black Zytel handle	\$90
350S	ComboEdge/satin finish blade, black Zytel handle	\$90
350SBT	ComboEdge/BT2 coated blade, black Zytel handle	\$100

Specifications— 2.95" Blade. Thickness: .088"; Overall length: 7.10"; Closed: 4.15"; Weight: 2.00oz; 154CM stainless steel blade hardened to (58-60 HRC), Zytel® handles with stainless steel locking-liner and removable black steel carry-clip.

MODEL 550 GRIPTILIAN

550	Plain edge/satin finish Sheepfoot blade, AXIS, blk hndl	\$95
550S	ComboEdge/satin finish Sheepfoot blade, AXIS, blk hndl	\$95
550SBT	ComboEdge/BT2 coated Shpsfoot blade, AXIS, blk hndl	\$105
550SBTRT	ComboEdge/BT2 blade, AXIS, Realtree Hardwoods hndl	\$115

550D	Plain edge/satin finish Sheepfoot blade, AXIS, olive hndl	\$95
550SOD	ComboEdge/satin finish Sheepfoot blade, AXIS, olive hndl	\$95
550BTOD	Plain edge/BT2 coated Shpsfoot blade, AXIS, olive hndl	\$105
550SBTOD	ComboEdge/BT2 coated Shpsfoot blade, AXIS, olv hndl	\$105

550T	Trainer/smooth finish Sheepfoot blade, AXIS, red handle	\$75
550/SW	Hunter's Pack/Model 550, Rescue Hook & combo shth	\$120

Specifications— 3.45" Blade. Thickness: .115"; Overall length: 8.07"; Closed: 4.62"; Weight: 3.25oz; 440C stainless steel Modified Sheepfoot blade (58-60 HRC), Molded Noryl GTX® handle; AXIS lock with oval thumb-hole opener; Reversible, carry-clip.

ITEM NUMBER	BLADE & HANDLE STYLE DESCRIPTION	SUGGESTED RETAIL
MODEL 551 GRIPTILIAN		
551	Plain edge/satin finish Drop-point blade, AXIS, blk hndl	\$95
551S	ComboEdge/satin finish Drop-point blade, AXIS, blk hndl	\$95
551SBT	ComboEdge/BT2 coated Drop-point blade, AXIS, blk hndl	\$115
551SBTRT	ComboEdge/BT2 blade, AXIS, Realtree Hardwoods hndl	\$110
5510D	Plain edge/satin finish Sheepfoot blade, AXIS, olive hndl	\$95
551SOD	ComboEdge/satin finish Shpsfoot blade, AXIS, olive hndl	\$95
551BTOD	Plain edge/BT2 coated Shpsfoot blade, AXIS, olive hndl	\$105
551SBTOD	ComboEdge/BT2 coated Shpsfoot blade, AXIS, olv hndl	\$105
551T	Trainer/smooth finish Sheepfoot blade, AXIS, red handle	\$75
551/5W	Hunter's Pack/Model 551, Rescue Hook & combo shth	\$120

Specifications— 3.45" Blade. Thickness: .115"; Overall length: 8.07"; Closed: 4.62"; Weight: 3.25oz; 440C stainless steel Mod. Drop-point blade (58-60 HRC), Molded Noryl GTX® handle; AXIS lock with dual thumb-stud opener; Reversible, carry-clip.

MODEL 555 MINI-GRIPTILIAN

555	Plain edge/satin finish Sheepfoot blade, AXIS, black hndl	\$85
555S	ComboEdge/satin finish Sheepfoot blade, AXIS, blk hndl	\$85
555-GRN	Plain edge/satin Sheepfoot blade, AXIS, green handle	\$85
555S-GRN	ComboEdge/satin Sheepfoot blade, AXIS, green handle	\$85
555-PUR	Plain edge/satin Sheepfoot blade, AXIS, purple handle	\$85
555S-PUR	ComboEdge/satin Sheepfoot blade, AXIS, purple handle	\$85
555-BLU	Plain edge/satin Sheepfoot blade, AXIS, blue handle	\$85
555S-BLU	ComboEdge/satin Sheepfoot blade, AXIS, blue handle	\$85
555-YEL	Plain edge/satin Sheepfoot blade, AXIS, yellow handle	\$85
555S-YEL	ComboEdge/satin Sheepfoot blade, AXIS, yellow handle	\$85
5550D	Plain edge/satin Sheepfoot blade, AXIS, olive handle	\$85
555SOD	ComboEdge/satin Sheepfoot blade, AXIS, olive handle	\$85
555BTOD	Plain edge/BT2 coated Sheepfoot blade, AXIS, olv hndl	\$95
555SBTOD	ComboEdge/BT2 coated Sheepfoot blade, AXIS, olv hndl	\$95

Specifications— 2.91" Blade. Thickness: .100"; Overall length: 6.78"; Closed: 3.87"; Weight: 2.56oz; 440C stainless steel Mod. Sheepfoot blade (58-60 HRC), Molded Velox® handle; AXIS lock with oval thumb-hole opener; Reversible, carry-clip.

MODEL 556 MINI-GRIPTILIAN

556	Plain edge/satin finish Drop-point blade, AXIS, black hndl	\$85
556S	ComboEdge/satin finish Drop-point blade, AXIS, blk hndl	\$85
556-GRN	Plain edge/satin Drop-point blade, AXIS, green handle	\$85
556S-GRN	ComboEdge/satin Drop-point blade, AXIS, green handle	\$85
556-PUR	Plain edge/satin Drop-point blade, AXIS, purple handle	\$85
556S-PUR	ComboEdge/satin Drop-point blade, AXIS, purple handle	\$85
556-BLU	Plain edge/satin Drop-point blade, AXIS, blue handle	\$85
556S-BLU	ComboEdge/satin Drop-point blade, AXIS, blue handle	\$85

2003 RETAIL PRICE LIST

ITEM NUMBER	BLADE & HANDLE STYLE DESCRIPTION	SUGGESTED RETAIL
-------------	----------------------------------	------------------

MODEL 556 MINI-GRIPTILIAN *cont'd*

556-YEL	Plain edge/satin Drop-point blade, AXIS, yellow handle	\$85
556S-YEL	ComboEdge/satin Drop-point blade, AXIS, yellow handle	\$85
5560D	Plain edge/satin Sheepsfoot blade, AXIS, olive handle	\$85
55650D	ComboEdge/satin Sheepsfoot blade, AXIS, olive handle	\$85
556BT0D	Plain edge/BT2 coated Sheepsfoot blade, AXIS, olv hndl	\$95
556SBT0D	ComboEdge/BT2 coated Sheepsfoot blade, AXIS, olv hndl	\$95

Specifications— 2.91" Blade. Thickness: .100"; Overall length: 6.78"; Closed: 3.87"; Weight: 2.56oz; 440C stainless steel Mod. Sheepsfoot blade (58-60 HRC), Molded Velox® handle; AXIS lock with dual thumb-stud opener; Reversible, carry-clip.

MODEL 690

690	Plain edge/satin blade, Carbon Fiber/rosewood hndl	\$180
690S	ComboEdge/satin blade, Carbon Fiber/rosewood hndl	\$180
690BC1	Plain edge/BC1 blade, Carbon Fiber/rosewood hndl	\$200
690SBC1	ComboEdge/BC1 blade, Carbon Fiber/rosewood hndl	\$200

Specifications— 3.25" Blade. Thickness: .133"; Overall length: 7.50"; Closed: 4.12"; Weight: 3.00oz; 154CM stainless steel blade hardened to (58-60 HRC), Carbon Fiber/stabilized hardwood rose color handles with blue anodized titanium modified locking-liner; Movable thumb-stud; Custom removable steel tear-drop carry-clip.

MODEL 705 (M.C. HENRY & WILLIAMS)

705	Plain edge/satin finish blade, AXIS lock, G10 scales	\$130
705S	ComboEdge/satin finish blade, AXIS lock, G10 scales	\$130
705SBT	ComboEdge/BT2 coated blade, AXIS lock, G10 scales	\$140

Specifications— 2.95" Blade. Thickness: .100"; Overall length: 6.75"; Closed: 3.80"; Weight: 2.70oz; 154CM stainless steel blade hardened to (58-60 HRC), G10 handle scales; AXIS lock with dual thumb-stud opener; Reversible, black steel carry-clip.

MODEL 710 (M.C. HENRY & WILLIAMS)

710	Plain edge/satin finish blade, AXIS, G10 scales	\$160
710S	ComboEdge/satin finish blade, AXIS lock, G10 scales	\$160
710SBT	ComboEdge/BT2 coated blade, AXIS lock, G10 scales	\$170
710HS	M2 steel/plain edge/BT2 coated blade, AXIS, G10 scsls	\$180
710HSSR	M2 steel/ComboEdge/BT2 coated blade, AXIS, G10 scsls	\$180
710T	Trainer/smooth finish blade, AXIS, red handle	\$140

Specifications— 3.90" Blade. Thickness: .115"; Overall length: 8.80"; Closed: 4.90"; Weight: 4.50oz; 154CM stainless steel blade hardened to (58-60 HRC), M2 high-speed steel model (60-62HRC), G10 handle scales; AXIS lock with dual thumb-stud openers; Reversible, black steel carry-clip.

MODELS 720 & 721 (PARDUÉ)

720	Plain edge/satin finish Bowie, AXIS, aluminum handle	\$150
720S	ComboEdge/satin finish Bowie, AXIS, alum. hndl	\$150
720SBT	ComboEdge/BT2 coated Bowie, AXIS, alum. hndl	\$160
720SBTRT	ComboEdge/BT2 ctd Bowie, Realtree Hardwoods G10 hndl	\$170
721	Plain edge/satin finish Bowie blade, AXIS, G10 hndl	\$175

ITEM NUMBER	BLADE & HANDLE STYLE DESCRIPTION	SUGGESTED RETAIL
-------------	----------------------------------	------------------

MODELS 720 & 721 *cont'd*

721S	ComboEdge/satin finish Bowie blade, AXIS, G10 hndl	\$175
721SBT	ComboEdge/BT2 coated Bowie blade, AXIS, G10 hndl	\$185

Specifications— 3.25" Blade. Thickness: .115"; Overall length: 7.62"; Closed: 4.37"; Weight: 4.30oz aluminum or 3.82oz G10; 154CM stainless steel Bowie blade hardened to (58-60 HRC), Black anodized handle; AXIS lock with dual thumb-stud opener; Movable, black steel carry-clip.

MODEL 722 (PARDUÉ)

722	Plain edge/satin finish Tanto blade, AXIS, G10 hndl	\$175
722S	ComboEdge/satin finish Tanto blade, AXIS, G10 hndl	\$175
722SBT	ComboEdge/BT2 coated Tanto blade, AXIS, G10 hndl	\$185

Specifications— 3.25" Blade. Thickness: .115"; Overall length: 7.62"; Closed: 4.37"; Weight: 3.82oz; 154CM stainless steel Tanto blade hardened to (58-60 HRC), Black G10 handle; AXIS lock with dual thumb-stud opener; Movable, black steel carry-clip.

MODEL 730 & 735 ARES

730	Plain edge/satin finish blade, AXIS, Burg/blk G10 scales	\$140
730S	ComboEdge/satin finish blade, AXIS, Burg/blk G10 scsls	\$140
730SBT	ComboEdge/BT2 coated blade, AXIS, Burg/blk G10 scsls	\$150
735	Plain edge/satin finish blade, AXIS, Green/blk G10 scsls	\$140
735S	ComboEdge/satin finish blade, AXIS, Green/black G10	\$140
735SBT	ComboEdge/BT2 coated blade, AXIS, Green/black G10	\$150

Specifications— 3.60" Blade. Thickness: .114"; Overall length: 8.20"; Closed: 4.70"; Weight: 4.40oz; 154CM stainless steel blade hardened to (58-60 HRC), Colored G10 handle scales; AXIS lock with dual thumb-stud opener; Movable, black steel carry-clip.

MODEL 770 (OSBORNE)

770	Plain edge/satin finish blade, AXIS, Carbon Fiber hndl	\$200
770BC1	Plain edge/BC1 coated blade, AXIS, Carbon Fiber hndl	\$220

Specifications— 2.80" Blade. Thickness: .094"; Overall length: 6.50"; Closed: 3.70"; Weight: 1.60oz; 154CM stainless steel blade hardened to (58-60 HRC), Black Carbon Fiber handles; AXIS lock with dual thumb-stud opener; Custom removable carry-clip.

MODEL 771, 771-01 & 773

771	Plain edge/satin finish blade, AXIS, alum. silver hndl	\$145
771BC1	Plain edge/BC1 coated blade, AXIS, alum. silver hndl	\$160
773	Plain edge/satin finish blade, AXIS, alum. black hndl	\$145
773BC1	Plain edge/BC1 coated blade, AXIS, alum. black hndl	\$160
771-01	Plain edge/satin finish blade, AXIS, alum. red/blk hndl	\$155
771BC1-01	Plain edge/BC1 coated blade, AXIS, alum. red/blk hndl	\$170

Specifications— 2.80" Blade. Thickness: .094"; Overall length: 6.50"; Closed: 3.70"; Weight: 1.70 oz; 154CM stainless steel blade (58-60 HRC), Aluminum handles (various colors); AXIS lock with dual thumb-stud opener; Removable carry-clip.

MODEL 921 SWITCHBACK

921	Plain edge/satin finish Wharnciff blade, AXIS, alum hndl	\$190
921S	ComboEdge/satin finish Wharnciff blade, AXIS, alum hndl	\$190

ITEM NUMBER	BLADE & HANDLE STYLE DESCRIPTION	SUGGESTED RETAIL
-------------	----------------------------------	------------------

MODEL 805 TSEK AXIS

805	Plain edge/satin finish blade, AXIS lock, blk G10 scales	\$130
805S	ComboEdge/satin finish blade, AXIS lock, blk G10 scsls	\$130
805SBT	ComboEdge/BT2 coated blade, AXIS lock, blk G10 scsls	\$140

Specifications— 3.93" Blade. Thickness: .124"; Overall length: 9.36"; Closed: 5.43"; Weight: 4.74oz; 440C stainless steel blade (58-60HRC); Double, 410 stainless steel liners; AXIS lock; G10 scales; Movable, black steel carry-clip.

MODEL 806D2 AFCK AXIS

806D2	Plain edge/BT2 coated blade, AXIS lock, blk G10 scsls	\$175
806SD2	ComboEdge/BT2 coated blade, AXIS lock, blk G10 scsls	\$175

Specifications— 3.94" Blade. Thickness: .124"; Overall length: 9.37"; Closed: 5.43"; Weight: 4.78oz; D2 tool steel blade (59-61HRC); Double, 410 stainless steel liners; AXIS lock; G10 scales; Movable, black steel carry-clip.

MODEL 813 MINI-TSEK

813	Plain edge/satin finish blade, black G10 scales	\$85
813S	ComboEdge/satin finish blade, black G10 scales	\$85
Specifications—	3.16" Blade. Thickness: .097"; Overall length: 7.62"; Closed: 4.46"; Weight: 3.10oz; 440C stainless steel blade (58-60HRC); Double, 410 stainless steel liners; Modified locking-liner; Black G10 scales; Removable, black steel carry-clip.	

MODEL 814 MINI-AFCK-II

814	Plain edge/satin finish blade, black G10 scales	\$100
814S	ComboEdge/satin finish blade, black G10 scales	\$100
814SBT	ComboEdge/BT2 coated blade, black G10 scales	\$110
814SBTRT	ComboEdge/BT2 coated blade, Realtree Hardwoods scsls	\$120
814T	Trainer/tumble finish blade, AXIS, red G10 scales	\$70

Specifications— 3.25" Blade. Thickness: .097"; Overall length: 7.65"; Closed: 4.40"; Weight: 3.00oz; 154CM stainless steel blade (58-60 HRC); Double, 410 stainless steel liners; Black G10 scales; Removable, black steel carry-clip.

MODEL 821 MINI-ASCENT-II UTILITY

821	Plain edge/satin finish blade, black Zytel handle	\$55
821S	ComboEdge/satin finish blade, black Zytel handle	\$55

Specifications— 2.90" Blade. Thickness: .110"; Overall length: 6.95"; Closed: 4.00"; Weight: 1.80oz; 440C stainless steel blade (58-60 HRC); Thumb-stud opener with lock-back mechanism; Black Zytel® handle; Removable, black steel carry-clip.

MODEL 824 MINI-ASCENT-II

824	Plain edge/satin finish blade, black Zytel handle	\$55
824S	ComboEdge/satin finish blade, black Zytel handle	\$55
824SBT	ComboEdge/BT2 coated blade, black Zytel handle	\$65

Specifications— 2.90" Blade. Thickness: .110"; Overall length: 6.95"; Closed: 4.00"; Weight: 1.80oz; 154CM stainless steel blade (58-60 HRC); Ambidextrous oval-hole opener with lock-back mechanism; Black Zytel® handle; Removable, steel carry-clip.

Model 921 Specifications— 3.40" Blade. Thickness: .115"; Overall length: 7.87"; Closed: 4.47"; Weight: 2.90oz; S30V Wharnciff blade (58-60HRC); Small Blade: 2.00"; 440C; Blue anodized hndl; AXIS lock/dual thumb-stud opener; Movable, steel carry-clip.

ITEM NUMBER	BLADE & HANDLE STYLE DESCRIPTION	SUGGESTED RETAIL
-------------	----------------------------------	------------------

MODEL 831 ASCENT-II UTILITY

831	Plain edge/satin finish blade, black Zytel handle	\$65
831S	ComboEdge/satin finish blade, black Zytel handle	\$65
831/5W	Hunter's Pack/Model 831, Rescue Hook & combo shtg	\$90

Specifications— 3.40" Blade. Thickness: .115"; Overall length: 8.25"; Closed: 4.85"; Weight: 2.70oz; 440C stainless steel blade (58-60HRC); Thumb-stud opener with lock-back mechanism; Black Zytel® handle; Movable, black steel carry-clip.

MODEL 834 ASCENT-II

834	Plain edge/satin finish blade, black Zytel handle	\$65
834S	ComboEdge/satin finish blade, black Zytel handle	\$65
834SBT	ComboEdge/BT2 coated blade, black Zytel handle	\$75

Specifications— 3.50" Blade. Thickness: .115"; Overall length: 8.25"; Closed: 4.85"; Weight: 2.70oz; Clip-point 154CM stainless steel blade (58-60 HRC); Ambidextrous oval-opener hole, lock-back mechanism; Black Zytel® handle; Movable, steel carry-clip.

MODEL 905 MINI-STRYKER

905	Plain edge/satin finish blade, black G10 scales	\$105
905S	ComboEdge/satin finish blade, black G10 scales	\$105
905SBT	ComboEdge/BT2 coated blade, black G10 scales	\$115

Specifications— 2.90" Blade. Thickness: .100"; Overall length: 7.10"; Closed: 4.10"; Weight: 2.70oz; 154CM stainless steel blade (58-60 HRC); Ambidex. opener disk with double, Titanium locking-liners; Black G10 scales; Removable black steel carry-clip.

MODEL 910 STRYKER

910	Plain edge/satin finish blade, black G10 scales	\$120
910S	ComboEdge/satin finish blade, black G10 scales	\$120
910SBT	ComboEdge/BT2 coated blade, black G10 scales	\$130
910HS	M2 steel/plain edge/BT2 coated blade, blk G10 scales	\$140
910HSSR	M2 steel/ComboEdge/BT2 coated blade, blk G10 scales	\$140
910T	Trainer/tumble finish blade, red G10 scales	\$90

Specifications— 3.70" Blade. Thickness: .125"; Overall length: 8.25"; Closed: 4.68"; Weight: 3.80oz; 154CM stainless steel blade (58-60 HRC) or M2 high-speed steel (60-62 HRC); Ambidextrous opener-disk; double, Titanium liners; G10 scales; Carry-clip.

MODELS 940 & 942 (OSBORNE)

940	Plain edge/sat. finish MR Tanto blade, AXIS, green anodzd	\$175
940S	ComboEdge/sat. finish MR Tanto blade, AXIS, green anodzd	\$175
940SBT	ComboEdge/BT2 coated MR Tanto blade, AXIS, grn anodzd	\$185
942	Plain edge/sat. finish MR Tanto blade, AXIS, black anodzd	\$175
942S	ComboEdge/sat. finish MR Tanto blade, AXIS, black anodzd	\$175
942SBT	ComboEdge/BT2 coated MR Tanto blade, AXIS, blk anodzd	\$185

Specifications— 3.40" Blade. Thickness: .115"; Overall length: 7.87"; Closed: 4.47"; Weight: 2.90oz; 154CM stainless steel Modified Reverse Tanto blade (58-60HRC); Ambidex. dual thumb-stud opener; double, 410 stainless steel liners; Color anodized alum. handle scales with color anodized titanium back-spacers; Movable carry-clip.

2003 RETAIL PRICE LIST

ITEM NUMBER	BLADE & HANDLE STYLE DESCRIPTION	SUGGESTED RETAIL
-------------	----------------------------------	------------------

MODELS 941 & 943 (OSBORNE)

941	Plain edge/sat. finish Clip-point blade, AXIS, grn anodzd	\$175
941S	ComboEdge/sat. finish Clip-point blade, AXIS, grn anodzd	\$175
941SBT	ComboEdge/BT2 coated Clip-point blade, AXIS, grn anodzd	\$185
943	Plain edge/sat. finish Clip-point blade, AXIS, blk anodzd	\$175
943S	ComboEdge/sat. finish Clip-point blade, AXIS, blk anodzd	\$175
943SBT	ComboEdge/BT2 coated Clip-point blade, AXIS, blk anodzd	\$185

Specifications— 3.40" Blade, Thickness: .115"; Overall length: 7.87"; Closed: 4.47"; Weight: 2.62oz; 154ClM stainless steel Straight Clip-point blade (58-60HRc); Ambidex. dual thumb-stud opener; double, 410 stainless steel liners; Color anodized aluminum handle scales with color anodized titanium back-spacers; Movable carry-clip.

PRESTIGEDGES KITCHEN CUTLERY

4501	3-Piece set/8" Chef/6" Utility/3.5" Paring Knives come in black presentation case	\$400
-------------	---	-------

Specifications— Single-piece, full-tang 440C stainless steel blades, Impregnated real wood laminate and woven Micarta bolster handles; nickel/silver rivet assembly; 3-piece set comes in attractive presentation case with spring-hinged lid

MODEL 31 BALI-SONG

31	3" Bali-Song/plain edge Clip-pnt blade, Titanium hndls	\$150
31S	3" Bali-Song/ComboEdge Clip-pnt blade, Ti-handles	\$150

Specifications— 2.98" Blade, Thickness: .125"; Overall length: 7.09"; Closed: 4.35" Weight: 3.10oz; Clipped-utility blade style 440C stainless steel blade, Skeletonized MIM Titanium handles with integrated Titanium latch

MODEL 40T TRAINER BALI-SONG

40T	4" Bali-Song/trainer blade, Titanium handles	\$120
40TR	4" Bali-Song/trainer blade, Titanium red handles	\$130

Specifications— 3.78" Blade, Thickness: .125"; Overall length: 9.00"; Closed: 5.20" Weight: 4.10 oz.; Skeletonized 440C stainless steel trainer blade, Skeletonized 6AL-4V Titanium handles with integrated Titanium spring-latch (Red handle is pvdcr coat finish)

MODEL 42, 43, 46 & 47 BALI-SONG

42	4" Bali-Song/plain edge Weehawk blade, Ti-handles	\$185
42S	4" Bali-Song/ComboEdge Weehawk blade, Ti-handles	\$185
42SS	4" Bali-Song/ComboEdge Weehawk blade, SSteel-handles	\$160
43	4" Bali-Song/plain edge Bowie blade, Titanium handles	\$185
46	4" Bali-Song/plain edge Spear-Point blade, Ti-handles	\$185
47	4" Bali-Song/plain edge Tanto blade, Titanium handles	\$185

Specifications— 4.20" Blade, Thickness: .125"; Overall length: 9.40"; Closed: 5.20" Weight: Titanium- 4.10oz, Stainless Steel- 7.80oz; Model specific blade styles 440C stainless steel blade, Skeletonized 6AL-4V Titanium handles with integrated steel spring-latch

THE BLUE BOX (TOOL KIT)

981084	Six-Lobe Screw bit driver (bit sizes 6-8, 10, 15), case	\$12
---------------	---	------

Specifications— Molded, blue plastic case 2.75" Length; 1.875" Width; Thickness: .625"; Weight: 1.60 oz.; Removable, plastic carry-clip.

ITEM NUMBER	BLADE & HANDLE STYLE DESCRIPTION	SUGGESTED RETAIL
-------------	----------------------------------	------------------

SOFT SHEATHS & SHEATH ACCESSORIES

981086	Soft sheath, small size (1.625" W x 5.00" D), black	\$10
981087	Soft sheath, large size (2.00" W x 5.25" D), black	\$10
981128	Soft sheath, Ball-Song (2.00" W x 5.25" D), black	\$10
981717	Soft sheath, Bali-Song Model 40 Series w/spring-latch, blk	\$10
981787	Soft sheath, Dual carry (2.00" W x 5.00" D), black	\$12

Specifications— Each made of black, 1680 denier poly-ballistic nylon; soft liners; edges finished with nylon; heavy stitch throughout; Velcro® closure with heavyweight poly webbing on backside for belt style carry. Dual carry features two pockets piggy-backed (same sheath used for knife Rescue Hook combo pack).

981607	Metal-Clip w/lash tab (fits Model 5, 100, 140, 145 & 160)	\$15
981608	Molded Belt-Loop w/bridge (Model 100, 140, 145)	\$10
981609	Tek-Lok®, large size	\$15
981610	Perma-Clips® for Tek-Lok®, large size (set of 2)	\$3.95
981611	Carry-Strap w/4-way lash-tab (metal-clip clips into)	\$10
981612	Lash-Tab Only (can be sewn on clothing or gear)	\$5

Specifications— Please refer to specific knife/sheath model pages or the Benchmade website for more information.

MILITEC-1® METAL CONDITIONER

981368	Militec-1, 1 oz. squeeze bottle	\$5.95
981369	Militec-1, The Sniper Pak (4 oz. squeeze bottle w/lip; stainless steel applicator needle); 1/4oz. bottle	\$19.95
981370	Militec-1, 4 oz. squeeze bottle	\$14.95
981371	Militec-1, Stainless steel applicator needle	\$10.00

Specifications— Same lubricant used in all benchmade knives. A chemically-reacted synthetic-based hydrocarbon derivative metal conditioner liquid that protects metal with a constant synthetic-based impregnated molecular bond.

The following are registered trademarks of Benchmade Knife Company, Inc., Oregon City, Oregon USA: Benchmade; Bali-Song; (butterfly logo); BT2; ComboEdge. • The following are trademarks of the Benchmade Knife Company, Inc., Oregon City, Oregon USA: Ares; Ascend; AXIS; Benchrite; Dark Star; Griptail; LEVIATOR; LifeSharp; Nimravus; Outboulder; Park Avenue; Pinnacle; Prestigedges; Reflex; Stryker; Switchback; TAC (Technically Advanced Cutlery); Held To A Higher Standard. • Note: We reserve the right to make any design and/or material modifications without prior notice. • Benchmade products are manufactured under one or more of the following patents: Safety Lock for Automatic Folding Knife— U.S. Patent No. 5,822,866; Blade Lock Mechanism for Folding Knife (Modified Locking Line)— U.S. Patent No. — 5,755,035; Pocket Knife With Lock (AVIS Lock)— U.S. Patent No. 5,737,841; Folding Knife (Design, Stryker Model)— U.S. Patent No. D408,706; Knife Blade (Design, Stryker Model)— U.S. Patent No. D409,070; Folding Knife With Grooved Handle (Design, Model 350, 3550)— U.S. Patent No. D397,017; Grooved Knife Handle (Design, Model 350, 3550)— U.S. Patent No. D397,020; Folding Knife (Design, Ascend Model)— U.S. Patent No. D385,173; Knife Design (Design, Ascend Model)— U.S. Patent No. D384,871; Portion Of A Blade For A Knife (Design, Pardue Model 720 Knife)— U.S. Patent No. D426,132; Knife Blade (Design, Model 140/145)— U.S. Patent No. D425,389; Knife Handle (Design, Model 705)— U.S. Patent No. D428,789. Other patents pending.

THE BENCHMADE WARRANTY

LIMITED LIFETIME WARRANTY— Benchmade Knife Company, Inc. warrants to the original owner that the knife will be free from defects in materials and workmanship. Benchmade will, without charge, repair or replace, at our (Benchmade's) option, any knife returned for Warranty work and found to be defective by Benchmade. The knife must be shipped by owner, prepaid and insured, together with a description of the problem and must be accompanied by the original bill of sale, your charge or credit receipt or any satisfactory proof of the original date of purchase. Any automatic knife returned for Warranty service from outside of Oregon must also include a copy of the owner's police or military ID, or be returned through the authorized Benchmade dealer from whom the knife was originally purchased. **NO EXCEPTIONS WILL BE MADE. WHAT IS COVERED—** This Warranty covers replacement parts and labor. **WHAT IS NOT COVERED—** This warranty does not cover normal wear, resharping of the blade, damage caused by neglect, misuse or the failure to perform normal or necessary maintenance, or shipping costs for returned knives.

DISASSEMBLY OF ANY KNIFE BY ANYONE OTHER THAN BENCHMADE'S OWN WARRANTY DEPARTMENT WILL VOID WARRANTY. NO EXCEPTIONS WILL BE MADE.

Please review the complete Warranty information and proper knife care instructions provided with each knife.

The purchase, use and ownership of knives is subject to a wide variety of local laws and regulations. It is impossible for Benchmade Knife Company to know or interpret all of these laws. It is the responsibility of the buyer to be aware of the laws which govern them in their specific area wherever that may be. We encourage the responsible ownership and use of knives as one of mankind's oldest tools. Be smart and be safe.

Benchmade is proud to be a charter member of AKTI. Get involved. Help to protect your knife freedoms— JOIN AKTI TODAY!

877.752.8770 or www.akti.org



IT'S AUTOMATIC— Benchmade

Knife Company manufactures what are arguably the finest automatic* knives available in the world today. • These knives are made to the same, exacting performance standards as the rest of our knives. • Here are just two of the **NEW!** models for the coming year!

VERY COOL,
COMPACT DESIGN
WITH SOLID ACTION—



**MODEL 3200
AUTO**

INTRODUCING THE
AUTO AXIS! TOTALLY
AMBIDEXTROUS
AUTO FUNCTION—



**MODEL 5000
AUTO AXIS**

*Within the United States, Automatic open knives are subject to compliance with the Federal Statutes of interstate commerce.



BENCHMADE KNIFE COMPANY, INC

300 Beaver Creek Road
Oregon City, Oregon 97045 USA

PHONE

1.800.800.7427
503.655.6004

FAX

503.655.6223
503.655.7922

EMAIL

info@benchmade.com

WEBSITE

www.benchmade.com